

CHAINS

RESTORED CORNER FOR OREGON STATE BOARD OF FORESTRY

Section corner common to Sections 2, 3, 10, 11,
T2S, R10W, W.M., Tillamook County, Oregon.

ORIGINAL

Post (now missing, found 1" x 20" iron pipe in place) from which a:

- 30" Hemlock bears S52E 9 lks.; now badly rotted stub 2' high.
- 40" Hemlock bears N74E 75 lks.; backcast of scribes R10W T2S S2 on 48" uproot.
- 10" Hemlock bears N75W 30 lks.; now just roots remaining in place.
- 20" Hemlock bears S32W 37 lks.; now 40", scribes BT visible, rest of face unexposed.

RESTORED

Var. 21½E

Set 4" x 4" x 52" white painted Cedar post 1.3' S.E. of above pipe from which a:

- 24" Hemlock bears N84½E 42.8 ft.; scribed T2S R10W S2 BT.
- 43" Hemlock bears N72W 17.1 ft.; scribed T2S R10W S3 BT RS401.
- 12" Hemlock bears S7E 46.6 ft.; scribed T2S R10W S11 BT.

Oregon State Board of Forestry metal location poster on original 20" BT.

Dated August 19, 1960

Restored by Harold J. Russell under my direction.
Harold Russell, Transitman

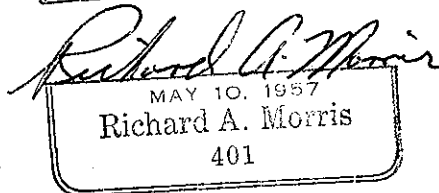
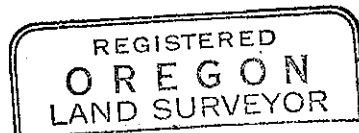

Present and witnessed by G. E. Nylund

407

Book I

407