

Form 974-0

U. S. DEPARTMENT OF AGRICULTURE
FOREST SERVICE

S. W. 1/4 Section
T. 6 S. R. 10 W. W. M. Mer.
Corner common to Sections
16, and 17

DESCRIPTION OF CORNER
Corner consists of a Nat. Found

on section above ground
with rocks, letters, figures, or notches, on perpendicular of edge.

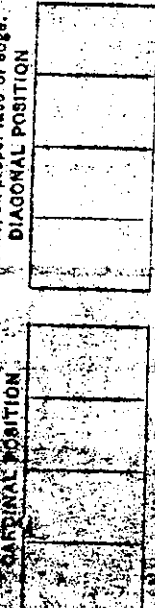

Kind of stone is located

Pls. are located
Sketch markings of Bearing, Trees (or Rocks) in proper box
and Distances in Link.

W	E	NW	SW	SE	NE

Species HEM HEM
Diameter 20" 8"
Bearing N35°E. S33°W
Distance 16 lbs. 8 lbs.

Do you believe this to be a genuine Land Office Corner?
If not, why?

John 1941
Signature
Date

John
Title

DATE:

PHOTO:

* = County corner tag affixed.

TITLE

REWITNESS

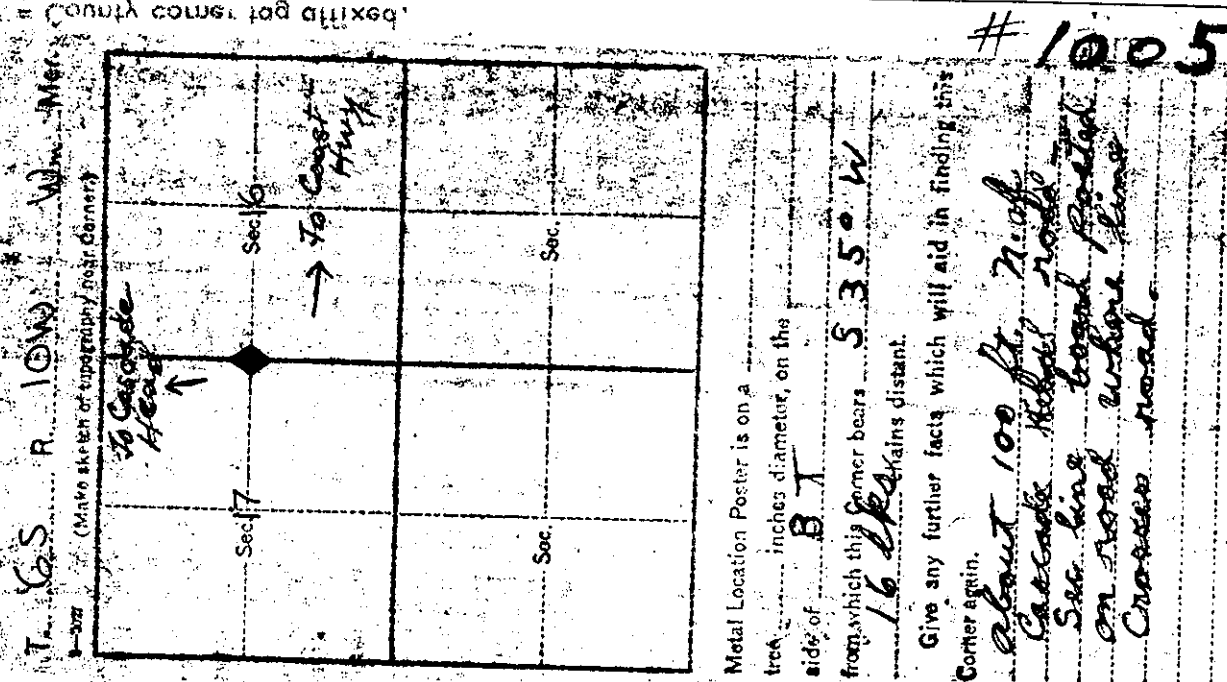

Metal Location Poster is on a
tree inches diameter, on the
side of BT
from which this corner bears S 35° W
16 lbs. chains distant.

Give any further facts which will aid in finding this
Corner again.
About 100 ft. N. of
Cascade Head road
See line board posted
on road where line
crosses road.

1005