

Form 574-9—Revised May, 1918

U. S. Department of Agriculture  
FOREST SERVICE

NATIONAL FOREST

CORNERS OF THE PUBLIC SURVEY

T. 6 S. R. 9 W. Hill, Mer.

Corner common to Sections

4, and 9

Corner consists of a Hemlock (root) in place

State condition Very Poor

Dimensions above ground inches

Sketch grooves, letters, figures, or notches, on proper face or edge.

CARDINAL POSITION DIAGONAL POSITION

Mound of \_\_\_\_\_ is located \_\_\_\_\_

Pits are located \_\_\_\_\_

Sketch markings of bearing trees (or rocks) in proper box and fill blanks below, giving bearings from corner to trees and distances in links.

N	S	E	NW	SW	SE	NE
See	See	See	See	See	See	See
Remarks	Remarks	Remarks	Remarks	Remarks	Remarks	Remarks

Species Rec. \_\_\_\_\_

Diameter 10" 20"

Bearing W 80° N S 15° W

Distance 8.1 lbs. 8 lbs.

Do you believe this to be a genuine Land Office Corner? Yes

If not, why? \_\_\_\_\_

#955

*Howard Stibbehead*  
Surveyor General (Title)

1-9-18 (Date)

4-7054

T. 6 S. R. 9 W. Hill, Mer.  
(Also sketch of topography near corner)

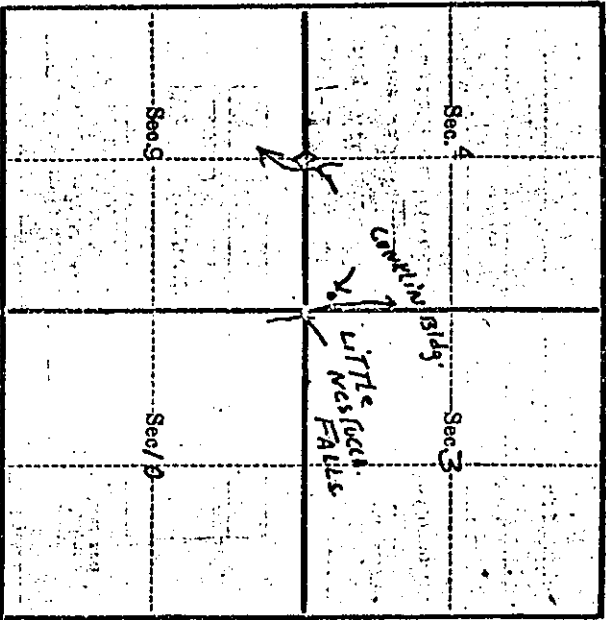

Metal Location Poster is on a \_\_\_\_\_

tree \_\_\_\_\_ inches diameter, on the \_\_\_\_\_

side of \_\_\_\_\_

from which this Corner bears \_\_\_\_\_

chains distant.

Give any further facts which will aid in finding this

Corner again. *Search 5/6 ST. did not find corner.*

*I did not open S 4 bearing trees. Small*

*slit revealed enough scribbling to identify*

*it as a PT. Field notes check. Original*

*corner was found prone on ground. One*

*small portion of original scribbling was*

*found. Set a new post in place and*

*marked 1 SW Keel.*

*Howard Stibbehead*  
12/3/18

U. S. Department of Agriculture Form 574-9 6-7204