

GOVERNMENT LOTS

TILLAMOOK COUNTY REWITNESS #921

4	3
13	14

C-W-NE 1/4 COR.

SEC.

24 T 55 R 11 W., WM.

HISTORICAL: G.L.O. Pg 13 5511 SET 12"X8"X6" STONE

CONDITION Good

FOUND, ORIGINAL 14"X8"X6" STONE MARKED XXXII

COMMENTS:

REWITNESS

1 SET 1 1/2" IRON PIPE WITH 3" BRASS CAP IN 10" CONCRETE CYLINDER

AT POSITION OF FOUND 14"X8"X6" ORIGINAL STONE MARKED XXXII

* 72" Hat Section NORTH 1 1/2 FEET

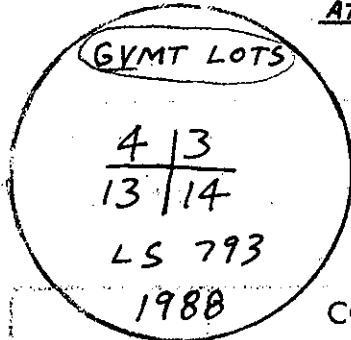

NEW ACCESSORY:

COMMENTS: THIS CORNER IS LOCATED IN A SWAMP IN AN OLD EAST-WEST FENCE LINE. LAYED FOUND STONE ALONGSIDE MONUMENT.

IN THE PRESENCE OF: AL DVORAK DAN McNUTT

DATE: 3-15-88

PHOTO#: 3-15-88

Allen E. Simpson, C.S.

TITLE

County corner tag affixed.