

CORNER RECORD (PERPETUATION)

MONUMENT: DESCRIBE NEW MONUMENT SET, OR WORK DONE TO PRESERVE EXISTING MONUMENT

Set 1 1/2" GALV. PIPE 5 FT. ABOVE GROUND.

#918

ACCESSORIES: DESCRIBE NEW BT'S WITNESS OBJECTS ETC. ESTABLISHED, OR WORK DONE TO PRESERVE EXISTING EVIDENCE

New BT's

6 in. HEM, N. 31° 30' W., 39 LKS. MARKED T 5 S R 11 W S 35 BT.

4 in. HEM, N. 7° E., 16 LKS. MARKED X BT. ONE FOOT ABOVE GROUND.

4 3/4 in. SPRUCE, S. 30° W., 39 LKS. MARKED T 6 S R 11 W S 2 BT

Work Done By \_\_\_\_\_ Title \_\_\_\_\_ Date \_\_\_\_\_ State Registration No. or Agency \_\_\_\_\_

Certified Cor. Record Prepared? Yes No Filed At: \_\_\_\_\_ Date \_\_\_\_\_

REMARKS

Witnessed By: MERVIN WHITMORE  
LESTER FULTZ

Tract or Surv. No. \_\_\_\_\_

Cor. No. \_\_\_\_\_

CORNER RECORD (SEARCH)

Tract or Survey No. \_\_\_\_\_

Cor. No. Z-21

Index File No. \_\_\_\_\_

T 5 R 11 W

R.D. HEBB County TILLAMOOK

Merid. \_\_\_\_\_

N.F. SIVSLAW State ORE.

CORNER DIAGRAM

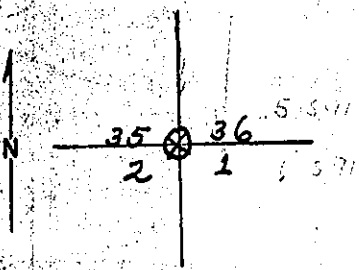

DESCRIBE CORNER MONUMENT FOUND

FOUND 3"x3" WOOD STAKE 8" ABOVE GROUND IN POOR CONDITION WITH MARKS ROTTED AWAY. FOUND SMALL KNOTS ON POST CUT OFF BY AXE. IN MY OPINION THIS IS A REMNANT OF THE ORIGINAL POST.

DESCRIBE BEARING TREES OR OTHER OFFICIAL ACCESSORIES FOUND

FOUND 3 3/4" SPRUCE STUB, S. 74° E., (NOT S. 68° E., AS IN ORIG. NOTES) 15 LKS. WITH VISIBLE MARKS S 1.

FOUND 1 1/2 in. ROTTED HEM. STUB, S. 7° W. (NOT S. 11° E. AS IN ORIG. NOTES) 14 LKS. WITH VISIBLE MARKS "BT".

THE N.W. AND N.E. BT'S ARE GONE.

DESCRIBE CORNER LOCATION RELATIVE TO NEAR BY FEATURES, ALSO HOW TO REACH CORNER

PHOTO IDENTIFICATION DATA

Photo No. \_\_\_\_\_

Filed At. \_\_\_\_\_

Object Ident. \_\_\_\_\_

Ident. By \_\_\_\_\_

Signature

PLANE COORDINATE POSITION DATA

State \_\_\_\_\_ Zone \_\_\_\_\_

X \_\_\_\_\_

Y \_\_\_\_\_

Estab. By \_\_\_\_\_

Agency

Title

Division

Headquarters

Date

5680-2

REV. '65

Signature Leonard Whitmore

Title Forestry Tech Division Timber

Headquarters Hebo

Date 9-6-65