

GOVERNMENT LOTS

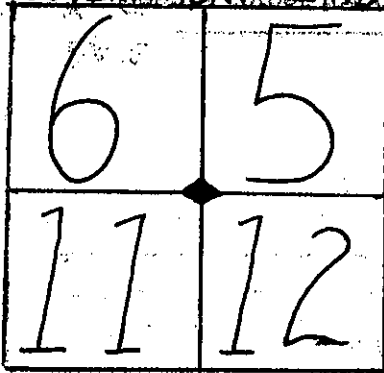

TILLAMOOK COUNTY REWITNESS

#878

SEC.

8

T 5S

R 10

W., WM.

CE-NW 1/64 COR.

HISTORICAL: G.L.O. P. 24 5510 SET 15x12x6 STONE 1872

BK.	Pg.		
HAYS E.	124		
10	56		

CONDITION GOOD

FOUND: 16" x 9" x 8" STONE SET ON END NO MARKS G.L.O. P. 24

NOT FOUND	14" SPRUCE	N 10° E	6 BLKS	BK. 10 Pg. 56

COMMENTS: CAN NOT FIND ANY OTHER STONES IN THE CORNER AREA. AREA WAS PROBED

REWITNESS

1 SET 1 1/2" IRON PIPE WITH 3" BRASS CAP IN 10" CONCRETE CYLINDER @ POSITION OF 16" X 9" X 8" STONE SET ON END (NO MARKS) 60" Hat Section 15' SOUTH

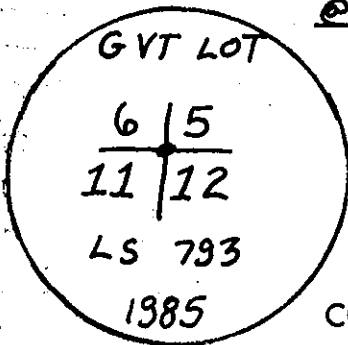

NEW ACCESSORY:

COMMENTS: THIS STONE WAS ACCEPTED AS THE CORNER

BECAUSE IT FIT REASONABLE FOR ORIGINAL SIZE (15" X 12" X 6") AND REASONABLE FOR POSITION SEE 1985 MAP BY F. GAYLORD. CORNER IS LOCATED ON THE WEST EDGE OF A SWAMPY SPRING (± 15' WEST OF CENTER) ± 75' SOUTH OF THE HEAD OF THE SPRING & ± 250' NORTH OF REDBERG RD. IN THE PRESENCE OF: DAN McNUTT, AL DVORAK, AL DUNCAN 4793

DATE: 4-29-85

PHOTO#:

TITLE

\* = County corner tag affixed.