

10 11
23 22

TILLAMOOK COUNTY REWITNESS #869

CW 1/16 SEC 18 T 55 R 10 W., WM.

HISTORICAL: GLO. SET 15" x 8" x 7" STONE 1872

BOOK PAGE	MAPS
	B-670
	B-680
	B-843

CONDITION GOOD

FOUND: 15" x 8" x 7" STONE ORIGINAL

COMMENTS:

REWITNESS

1 SET 1 1/2" IRON PIPE WITH 3" BRASS CAP IN 10" CONCRETE CYLINDER

@ POSITION OF FOUND 15" x 8" x 7" STONE SET VERTICALLY
* 72" Hat Section N 17° E 1 1/2 FEET

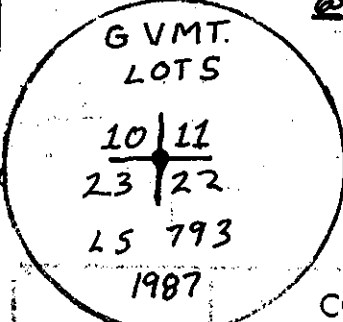

NEW ACCESSORY:

* 9" ALDER	S 40° E 5 1/2'	CW 1/16 S 18 BT CS
PP# 182402 (POWER PILE)	S. 4° W. 56 1/2'	A

(DISTANCES TO NAIL WITH BRASS WASHER)

COMMENTS: THIS CORNER IS LOCATED IN AN E-W-N FENCE CORNER. I LAID FOUND STONE ALONG SIDE CORNER.

IN THE PRESENCE OF: DAN MCNUTT AL DVORAK

DATE: 12-87

PHOTO#: MARCH 24, 1988

* County corner has affixed

TITLE