

TILLAMOOK COUNTY REWITNESS #859
 SEC. 7 T 55 R 10 W., WM.
 CW 1/16 COR.

HISTORICAL: G.L.O. Pg. 35 5510 1872
 ORIGINAL CALL SET STONE 14" X 8" X 6"

CONDITION GOOD	FOUND; 14" X 7" X 6" STONE MARKED XVI ORIGINAL

COMMENTS:

REWITNESS

1 SET 1 1/2" IRON PIPE WITH 3" BRASS CAP IN 10" CONCRETE CYLINDER
 @ POSITION OF FOUND 14" X 7" X 6" ORIGINAL STONE
 * 72" Hat Section NORTH 18 FEET VIS MARKED

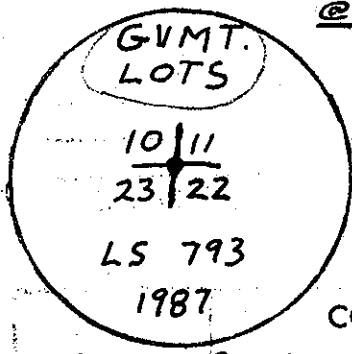

NEW ACCESSORY:

* 30" SPRUCE	S. 44° E. 1902'	CW 1/16 S7 B.T.CS
* 32" SPRUCE	S. 24° W. 226'	CW 1/16 S7 B.T.CS
DISTANCES MEASURED TO NAIL WITH BRASS WASHER IN FACE.		

COMMENTS: THIS CORNER IS LOCATED ± 10' SOUTH OF AN E-W FENCE LINE. LAYED FOUND STONE ALONG-SIDE MONUMENT.

IN THE PRESENCE OF: DAN MCNUTT AL DVORAK

DATE: 10-22-87 PHOTO# REC 10-27-87 TITLE

* = County corner tag affixed.