

GOVERNMENT LOTS	
9	10
24	23

TILLAMOOK COUNTY REWITNESS #858
 SEC. 7 T 55 R 10 W. WM.

C-W-W 1/64 COR.

HISTORICAL: G. L. O. Pg. 35 5510 1872

	ORIGINAL CALL	SET STONE 13" X 9" X 8"

CONDITION	GOOD	FOUND	ORIGINAL STONE 14" X 12" X 10" MARKED XXX11

COMMENTS:

REWITNESS

1 SET 1 1/2" IRON PIPE WITH 3" BRASS CAP IN 10" CONCRETE CYLINDER
 @ POSITION OF FOUND ORIGINAL 14" X 12" X 10" STONE MARKED XXX11
 * 72" Hat Section NORTH 15 FEET

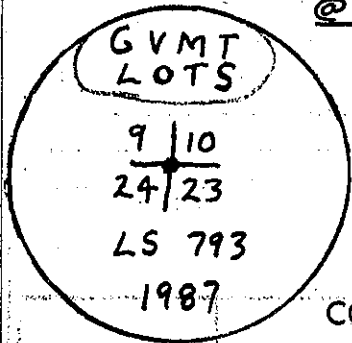

NEW ACCESSORY:

* 22" SPRUCE	S. 18° W. 153 1/4'	C-W-W 1/64 ST BTCS
* 31" SPRUCE	N. 88° W. 266'	C-W-W 1/64 ST BTCS
DISTANCES MEASURED TO NAIL WITH WASHER IN FACE.		

COMMENTS: THIS CORNER IS LOCATED 40' WEST OF A N-S-E FENCE CORNER AND REMAINS OF AN OLD FENCE TO THE WEST. LAYED FOUND STONE ALONGSIDE MONUMENT.

IN THE PRESENCE OF: DAN MCNUTT AL DVORAK

DATE: 10-26-87 PHOTO#: REC 1-27-87
 COUNTY CORNER TAG AFFIXED. LIFTWOOD CORNER TAG AFFIXED. TITLE: [unclear]