

CORNER RECORD (SEARCH)  
(Ref. FSM 7151.4)

Tract or  
Survey No.

Cor.  
No. R-701

Index  
File No. 4S R 9W

R.D. Hebo County TILLAMOOK

# 701

Merid. Will

N.F. SLUSLAW State ORE.

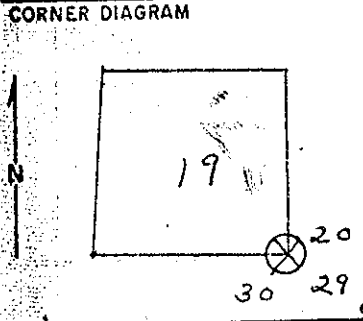

DESCRIBE CORNER MONUMENT FOUND GL 1878 SET POST + MKD

24" CEDAR, N. 33° E., 46 LKS.  
 30" CEDAR, N. 89° W., 95 LKS.  
 30" SNAG, S. 57° W., 259 LKS.  
 4" ALDER, S. 17° E., 23 LKS.

DESCRIBE BEARING TREES OR OTHER OFFICIAL ACCESSORIES FOUND

POST IS GONE.  
 FOUND 40" CEDAR, N. 38° E., 30 1/2 FT. WITH ORIG. SCRIBE  
 MKS. "S 20 THSR9 W BT. OLD F.S. TAG BY M.W. 11-11-58  
 FOUND 36" ALDER, S. 17° E., 15 1/2 FT. WITH HEALED WIT-  
 NESS FACE.

PHOTO IDENTIFICATION DATA

Photo No. E13-9-197

Filed At \_\_\_\_\_

Object Ident. \_\_\_\_\_

Ident. By \_\_\_\_\_  
*Signature*

DESCRIBE CORNER LOCATION RELATIVE TO NEAR-BY FEATURES, ALSO HOW TO REACH CORNER

PUT BT SIGNS ON WITNESSES & PAINT RED ON FACES  
 AND AROUND TREES.  
 THE NW BT IS FALLEN  
 THE SW BT HAS ROTTED FACE.  
 SET 3x3 CEDAR POST.  
 CORNER IS 12 FT NORTH OF A CREEK.

PLANE COORDINATE POSITION DATA

State \_\_\_\_\_ Zone \_\_\_\_\_

X \_\_\_\_\_

Y \_\_\_\_\_

Estab. By \_\_\_\_\_  
*Agency*

Signature Leonard Whitmore Title Forestry Tech. Technician Division Hebo Headquarters Hebo Date 4-29-69 7100-52 (3/68)

REWITNESS

I SET

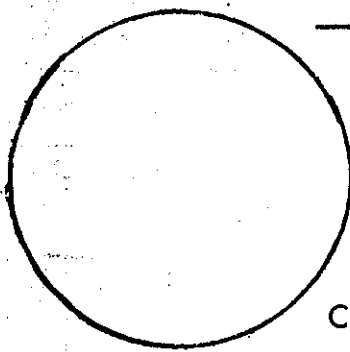

"x" "x" " Post N.W. feet  
 " Hat Section S. E.

NEW ACCESSORY:

COMMENTS: \_\_\_\_\_

IN THE PRESENCE OF: \_\_\_\_\_

DATE: \_\_\_\_\_ PHOTO#: \_\_\_\_\_ TITLE \_\_\_\_\_

\* = County corner tag affixed.