

CORNER RECORD (SEARCH)

Tract or Survey No.

Cor. No. L-5

Index

File No.

(Ref. FSM 7151.4)

T. 4S R. 9W

R.D. Hebo

County TILLAMOOK

State ORE.

#699

Merid. WILL.

N.F. SIUSLAW

State ORE.

CORNER DIAGRAM

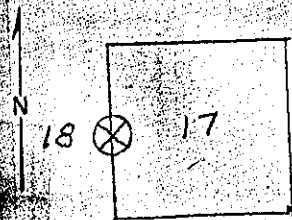

DESCRIBE CORNER MONUMENT FOUND

GLC 1898 SET POST + MKD.
48" SNA9, N. 65° E, 396 LKS.
50" SNA9, S. 85° W, 304 LKS.

DESCRIBE BEARING TREES OR OTHER OFFICIAL ACCESSORIES FOUND

M. WHITMORE, USFS, 5-8-58 BY RECORD FOUND FAINT
SCRIBE MKS. ON BOTH ORIG. BT'S
He re-witnessed 2 BT'S
24" SPRUCE, S. 23° 30' E, 38 FT. MKD. 1/4 S 17 BT.
10" FIR, N. 31° W, 49 1/2 FT. MKD. 1/4 S 18 BT.

PHOTO IDENTIFICATION DATA

Photo No. 9 EIJ-9-199

Filed At.

Object Ident.

Ident. By

Signature

PLANE COORDINATE POSITION DATA

State _____ Zone _____

X _____

Y _____

Estab. By _____

Agency

DESCRIBE CORNER LOCATION RELATIVE TO NEAR-BY FEATURES, ALSO HOW TO REACH CORNER

FOUND 3x3x48 WOOD POST WITH ROCK MOUND AT ITS BASE
FOUND WITNESSED TREES AS RECORDED BY WHITMORE.
PUT BT SIGNS + PAINT RED BAND AROUND BT'S

Signature

Leonard Whitmore

Title

Forestry Tech

Division

Timber

Headquarters

Hebo

Date

5-7-69

7100-52 (3/68)

no additional information

LEONARD (& MERVIN) IS WAS A DEPUTY COUNTY SURVEYOR QUALIFIED TO RE-WITNESS AUTHORITY ORIGINAL MONUMENTS. [unclear] 3/28/80 [unclear]