

Index File No. 2-23 CORNER RECORD (SEARCH) (Ref. FSM 7151.4) Tract or Survey No. _____ Cor. No. _____
 T 3S R. 10W R.D. HEBO County TILLA #648
 Merid. W.M. N.F. SIUSLAW State ORE.

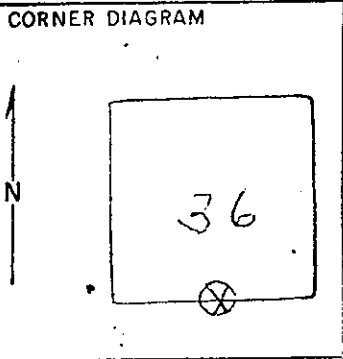

DESCRIBE CORNER MONUMENT FOUND GLO1979 SET FIR POST & MKD;
72" FIR, N.53°W, 121 LKS.
72" FIR, S.54°E, 94 LKS.

DESCRIBE BEARING TREES OR OTHER OFFICIAL ACCESSORIES FOUND
M. WHITMORE, 2-51 FOUND THE ORIGINAL FIR LIMB POST SHOWING AXE MARKS. ~~XXXXXXXXXXXX~~
BOTH ORIG. BT'S WERE ROTTED STUMPS.

PHOTO IDENTIFIC
 Photo No. _____ Signature Leonard Whitmore Title Surveyor Tech Division Timber Headquarters Hebo Date 4-76
 Filed At. _____

Object Ident. _____ DESCRIBE CORNER LOCATION RELATIVE TO NEAR-BY FEATURES, ALSO HOW TO REACH CORNER
 Ident. By 4-6-77
 Signature _____

PLANE COORDINATE POSITION D
 State _____ Zone _____
 X _____
 Y _____
 Estab. By _____ Agency _____
FOUND OLD 3"X5"X26" LIMB POST DECAYED & COVERED WITH MOSS - STILL STANDING - FLATTENED ON NORTH SIDE. THIS APPEARS TO BE THE ORIGINAL POST. A 1" GALV. PIPE STANDS ON ITS SOUTH SIDE.

ACCESSORIES : DESCRIBE NEW BT'S WITNESS OBJECTS ETC. ESTABLISHED, OR WORK DONE TO PRESERVE EXISTING EVIDENCE
FOUND 2 LARGE BADLY ROTTED DOWN STUMPS IN PROPER BEARING AND DISTANCES AS OF ORIGINAL RECORD.
A N-S RIDGE IS 2 1/2 CHAINS EAST AS OF ORIGINAL RECORDS.

Work Done By _____ Title _____ Date _____ State Registration No. _____
 Certified Cor. Record Prepared? Yes _____ No _____ Filed At _____ or Agency _____ Date _____

REMARKS
FOUND 11" FIR, N. 22° 30' W, 16 ⁵⁸ FT. WITH HEALED WITNESS FACE.
FOUND 17" FIR, S. 17° E, 53 ⁵ FT. WITH HEALED WITNESS FACE.
THESE TREES MAY HAVE BEEN MKD. BY OSBF.

Leonard Whitmore 4-6-77
 Index File No. _____ T. 3S R. 10W M. _____ Tract or Surv. No. _____ S 1/4 Cor _____