

Index File No. **S-3**

CORNER RECORD (SEARCH)
(Ref. FSM 7151.4)

Tract or Survey No. **#640**

T. **35** R. **10W**

R.D. **HEBO** County **TILLAMOOK**

Merid. **WILL.**

N.F. **SIVSLAW** State **ORE.**

CORNER DIAGRAM

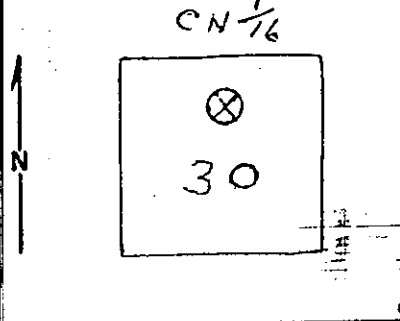

DESCRIBE CORNER MONUMENT FOUND
**W.A. ANDERSON, TILLAMOOK COUNTY ENGINEER, 1956
SET 2" IRON PIPE.**

DESCRIBE BEARING TREES OR OTHER OFFICIAL ACCESSORIES FOUND
**FOUND 2" IRON PIPE 22 FT. EAST OF THE EAST SIDE
HARD TOP SHOULDER OF SAND BEACH CAMPGROUND
ROAD.**

PHOTO IDENTIFICATION DATA

Photo No. _____
Filed At. _____
Object Ident. _____
Ident. By _____
Signature

DESCRIBE CORNER LOCATION RELATIVE TO NEAR-BY FEATURES, ALSO HOW TO REACH CORNER

PLANE COORDINATE POSITION DATA

Signature	Title	Division	Headquarters	Date	7100-52 (13/68)
<i>Leonard Whitmore</i>	<i>Forestry Tech</i>	<i>Timber</i>	<i>Hebo</i>	<i>12-14-76</i>	

Estab. By _____ Agency _____

CORNER RECORD (PERPETUATION)

MONUMENT: DESCRIBE NEW MONUMENT SET, OR WORK DONE TO PRESERVE EXISTING MONUMENT
**SET IRON FENCE POST 1 FT. NORTH OF CORNER - ATTACH PROPERTY
BOUNDARY SIGN.**

ACCESSORIES: DESCRIBE NEW BT'S WITNESS OBJECTS ETC. ESTABLISHED, OR WORK DONE TO PRESERVE EXISTING EVIDENCE
**SCRIBE 2 PINES:
4" PINE, N. 18° E, 120 FT. SCRIBED "1/6 BT." VAR. 21°
4" PINE, S. 1° E, 16 1/4 FT. SCRIBED "CN 1/6 BT." DISTANCES ARE TO SIDECENTERS**

Leonard Whitmore, Tillamook County Deputy Surveyor, 12-14-76

Work Done By _____ Title _____ Date _____ State Registration No. or Agency _____

Certified Cor. Record Prepared? Yes No Filed At: _____ Date _____

REMARKS
**LEONARD WHITMORE IS A DEPUTY COUNTY SURVEYOR EMPOWERED
TO REWITNESS RELIABLE ORIGINAL MONUMENTS.**

Op. L. G. Miller Tract or Surv. No. **Sec Cor. 30**

Index File No. **T. 35 R. 10W M.**