

Index
File No.

CORNER RECORD (SEARCH)
(Ref. FSM 7151.4)

Tract or
Survey No.

Cor.
No. R-15

T 3 S R 10 W

R.D. Hebo

County TILLAMOOK

633

Merid. Will.

N.F. SIUSLAW

State ORE.

CORNER DIAGRAM

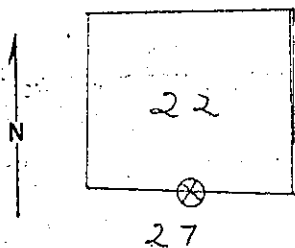

DESCRIBE CORNER MONUMENT FOUND GLO 1882 SET A POST AND MKD.
A 24" SNA9, N. 10° E., 17 LKS.
A 20" SNA9, S. 72° W., 10 LKS.

DESCRIBE BEARING TREES OR OTHER OFFICIAL ACCESSORIES FOUND
By Record M. WHITMORE, USFS, 3-19-52 FOUND 32" SNA9
S. 72° W., 10 LKS. WITH MARKS "1/4 SBT" VISIBLE AND A
30" SNA9, N. 10° E., 17 LKS. AS IN ORIGINAL NOTES, ALL
SCRIBING IS GONE.

PHOTO IDENTIFICATION DATA

Photo No. _____
Filed At. _____
Object Ident. _____
Ident. By _____
Signature

PLANE COORDINATE POSITION DATA

State _____ Zone _____
X _____
Y _____
Estab. By _____
Agency

DESCRIBE CORNER LOCATION RELATIVE TO NEAR-BY FEATURES, ALSO HOW TO REACH CORNER
WHITMORE SET 4x4x60 WOOD POST AND 1/2" PIPE 10" ABOVE
GROUND. HE MARKED 2 WITNESSES:
30" FIR, N. 7° E., 18 1/2 FT. MKD. 1/4 SBT.
24" FIR, S. 7° E., 12 FT. MKD. 1/4 SBT.
I FOUND THE BT'S IN PLACE AND SET 3/4" PIPE 30" ABOVE
GROUND. PUT BT SIGNS ON WITNESSES.

Signature
Leonard Whitmore

Title Forestry Tech
Divis Timber
Headquarters Hebo

Date 1-24-69

7100-52 (3/68)

REWITNESS

I SET

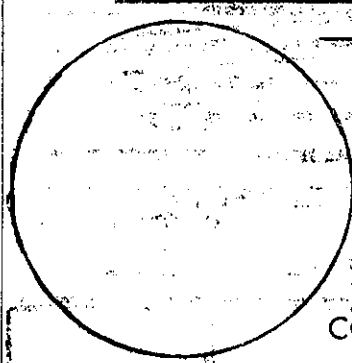

"x" "x" "Post N.W. 1 feet
" Flat Section S. E."

NEW ACCESSORY:

COMMENTS:

backside of front is blank

IN THE PRESENCE OF:

DATE:

PHOTO#:

County corner tag affixed.

TILLAMOOK COUNTY BEARING

TITLE