

TILLAMOOK COUNTY REWITNESS # 517

N.W. 1/4 SEC. 17/16
COR. 20/21 T 35 R 9 W., WM.
S. E.

SEC. COR NOW IN CREEK

HISTORICAL: GLO Pg. 33 359 SET STONE ± 1880

BK.	Pg.	MAPS
51	62	B-645 B-629
3	385	A-2612
		B-511
		A-1915

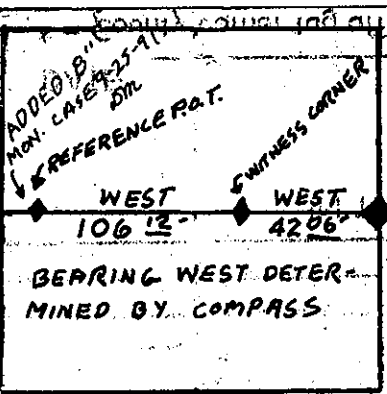

CONDITION	FOUND:
FD. GOOD NOW 40"	37" SPRUCE N. 63° W. 58 1/2 FT. BK. 3 Pg. 385
FD. SPLIT TRUNK	37" ALDER S. 37° W. 62 FT. BK. 3 Pg. 385
NOT FOUND IN CREEK	32" ALDER S. 66° E. 68 1/2 FT. BK. 3 Pg. 385
BRASS CAP SET BY W. RUST IS NOW GONE POSITION IN CREEK	

COMMENTS:

REWITNESS

1 SET 2" I.P. WITH 3" BRASS CAP IN 10" TILE & CEMENT FOR WITNESS CORNER & A 1/4" I.R. WITH 3" BRASS CAP IN THE ROAD FOR REFERENCE P.O.T. * 86" Hat Section N. E. 15 FEET

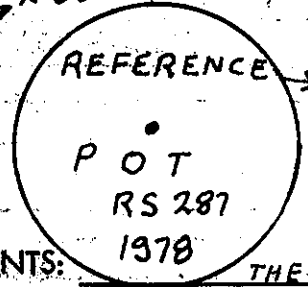
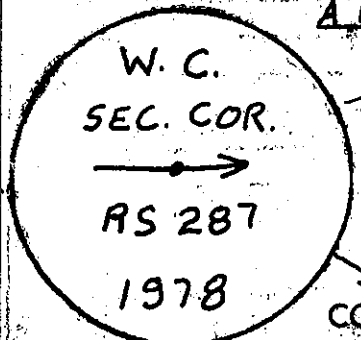

THE REFERENCE P.O.T. IS LOCATED IN THE CENTER OF THE SLY. DRIVING LANE OF EAST BEAVER CREEK ROAD & P.P.# 29 BE-D-5-R64 R30 BEARS S 44° W 21 55' Δ

COMMENTS: THE WITNESS CORNER TO THE SEC. COR. IS LOCATED ± 30' SLY. OF EAST BEAVER CREEK & ± 50' NLY. OF THE ROAD & AN 80° SPIKE IN THE ROOT OF A 36" SPRUCE (WHICH IS ALSO THE CORNER B.T.) BEARS N 18° W 30 1/2'. THE CORNER NOW FALLS IN THE CREEK. CORNER POSITION WAS DETERMINED FROM FD. B.T.S.

3-20-76 IN THE PRESENCE OF: GALE ARTHUR DAN MCNUCT
36" SPR NOW 55"
PP# 29 BE-D-5-R64 NOW# 202803

DATE: 3-22-78

PHOTO#: REC: LITVVOOR COUNTY BEAVER CREEK TITLE

* County corner tag affixed.