

TILLAMOOK COUNTY REWITNESS #314

SEC.

S. 1/16 COR. 22 | 23 T. | S R 10 W., WM.

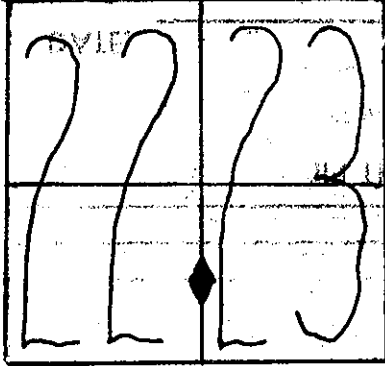

HISTORICAL:

MAP	Books	Page
MAP A-258	"H"	43
MAP A-493	"CT" G	150
MAP A-1852		

CONDITION

FOUND:

	Fd. Spruce limb with 1/2" Iron Pipe at 02 South.	Replaced spruce limb with Brass cap.

COMMENTS:

REWITNESS

1 SET 2" Iron Pipe with 3" Brass Cap -- I.P. is 6' long  
 10" TILE + CONCRETE 174 LEFT 2" PIPE AND SPRUCE LIMB  
 \* 96 " Flat Section 15 NORTH ALONG SIDE MONUMENT

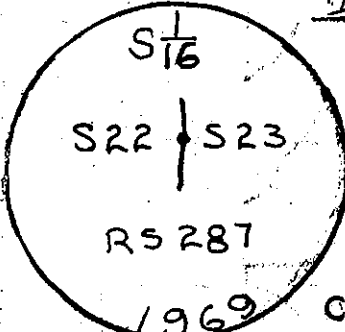

NEW ACCESSORY:

* 33" SPRUCE	S 23° W	54 45
* 40" Double Spruce	N 60° E	64 50

1969 COMMENTS: ONE TREE WITHIN INCHES OF ANOTHER ← Referred to above as a "Double Spruce" CORNER IS LOCATED ± 150' EAST OF BAYOCEAN ROAD AND ± 8' SOUTH OF THE TOE OF A FILL IN A SWAMP

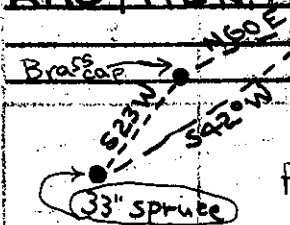

IN THE PRESENCE OF: AL Duncan

Field 1-20-70 George Urrey  
Gale Arthur

DATE: 8-4-70

PHOTO#: REC

TILLAMOOK COUNTY

TITLE

\* = County corner tag affixed.

GWA