

TRASK  
DLC # 37  
SE COR.  
of the N 1/2

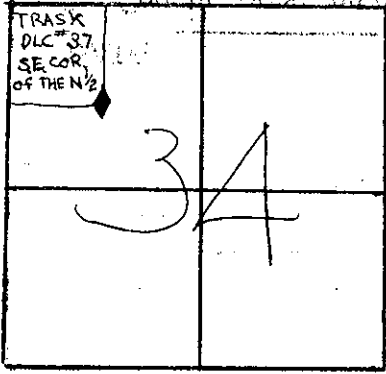

TILLAMOOK COUNTY REWITNESS

#262

SEC. 34

COR. N 1/2 TRASK T 1 S R 9 W., WM.  
DLC. # 37

S. East

HISTORICAL: 3" Iron Pipe by W.E. Anderson (1930) Refer to  
MAP B-320 also refer to note in section 28 159  
map and notes are filed survey for C.L. Robinson  
J.H. Scott found the corner in 1941 -- Refer to  
MAPS F-21-10 and F-21-9 R.H. Walker found corner 1949 (A-329)  
John L. Carllich found the corner in 1968 -- Refer to A-1557

CONDITION

FOUND: 3" Iron Pipe set by W.E. Anderson



COMMENTS:	Historical continued			MAPS	
	Book	Page	Year	A-329	F-21-10
	S3	50-54	1896	A-314	F-21-9
	H	66 & 32	1885	A-1557	B-320

REWITNESS

I SET 2" Iron Pipe with 3" Brass Cap SET IN CEMENT Q 15-78

"x "x " Post ~~W. WEST~~ 1 1/2 feet

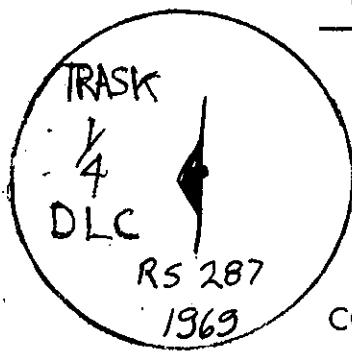
\* 96 " Hat Section ~~SE.~~



NEW ACCESSORY:

30" Hembok	S 16° W	43 1/2

COMMENTS: THIS CORNER IS LOCATED AT THE SW CORNER  
OF A PASTURE IN A FENCE CORNER FENCES RUN N-E-SW FROM  
CORNER.

IN THE PRESENCE OF:

George Urrey  
Gale Arthur

DATE: 12/10/69

PHOTO#:

\* = County corner tag affixed.

TITLE  
G.W.U.