

TILLAMOOK COUNTY REWITNESS # 183

N.W. SEC. 7 T. 15 R. 9 W., WM.

GLO-TISRLOW-Pg 7-1856

HISTORICAL:		Book-Page		MAPS	
A-11	1943	T-26	28 & 35	B-169	1919
B-148		4	43	F-40-63	1948
A-271	1916	S3	414	F-40-71	1915
B-535	1967	S3	232	F-41-44	1918
B-22		P-9	97	F-22-19	1929
F-21-1	1919	HAYS 'F'	101	A-136	1925
FOUND:		S3	44		

CONDITION

GONE	Spruce 64"	N82°E 71 <sup>28</sup>	GLO TISRLOW Pg 7
GONE	Willow 8"	S61°E 99 <sup>00</sup>	GLO TISRLOW Pg 7
OK	SW Cor. Cheese Factory	N65°48'W 254	BK 4 Pg 43 1946
OK	SE Cor. Cheese Factory	N57°01'E 23E	BK 4 Pg 43 1946
OK	N.W. Cor. School Hse	S30°30'W 237 <sup>3</sup>	BK 4 Pg 43 1946
GONE	MAPLE 4" UNMARKED	S24°E 27 <sup>72</sup>	HAYS BK 'F' Pg 101 1887
POSSIBLY	HATHAWAYS CHIMNEY	S13°W	HAYS BK 'F' Pg 101 1887
COMMENTS: OK	ELLIOTTS Kitchen Chimney	N70°E	HAYS BK 'F' Pg 101 1887
GONE	IRON PIPE IN E Road	South 516	T-26 B 35 & 28

TURN OVER & REFER TO "COMMENTS"

REWITNESS

1 SET 3" Brass Cap on 2" Iron Pipe in 90 LBS. Concrete AND Tile feet

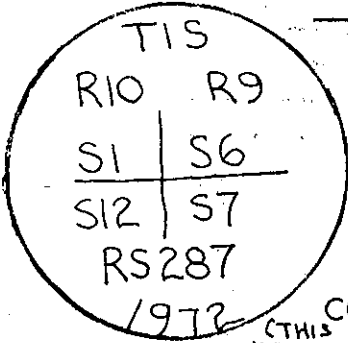

\*96" Hat Section: E. EAST 2°

NEW ACCESSORY:

BC-A-2-R59	S64°E 27 <sup>98</sup>	S7 BO CS (WITH Finish nail)
BC-A-2-R58	S67°W 47 <sup>29</sup>	S12

COMMENTS: Bk "P9" Pg 97 1925 Anderson & Gulstrom "Fd sec cor" which is a 1/2" Gas Pipe (fourth post from fence corner) Did not find gas pipe when a field search was made.

There is now a bunch of old dryers & washers staked around the corner, THANKS TO REX CAREY'S TV. & appliance. IN THE PRESENCE OF:

GEO WURREY GALE ARTHUR  
ROGAR KNIPPLE

DATE: 5-72

PHOTO#:

\* = County corner tag affixed.

TITLE

T 1 1 1	1510	151
	7	12
	6	1

TILLAMOOK COUNTY REWITNESS

N.W. **SEC** 67 T 15 R 10  
 S. E. **COR** 112 D.L.C.# 15 W., WM.

HISTORICAL:

CONDITION

COMMENTS:

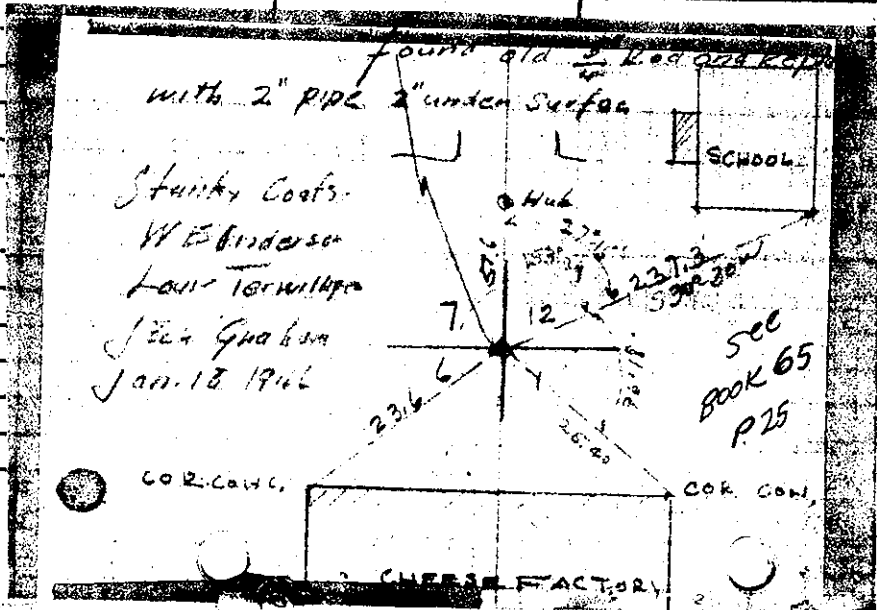

REWITNESS

I SET

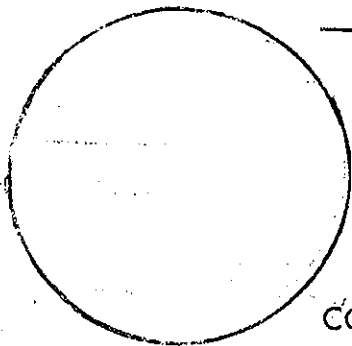

"x" "x" " Post N.W. feet  
 " Hat Section S. E.

NEW ACCESSORY:

COMMENTS:

IN THE PRESENCE OF:

DATE:

PHOTO#:

\* = County corner tag affixed.

TITLE

T1S.R10.W. T1S.R9.W.

1	6
12	7

TILLAMOOK COUNTY REWITNESS

SEC. COR. <sup>SEC.</sup> 116 T 15 R 9 & 10 W., WM.  
127

HISTORICAL: SEE PREVIOUS REWITNESS CARDS

<u>FOR HISTORY</u>		

CONDITION	FOUND:		

COMMENTS:

REWITNESS

1 SET 1 1/2" IRON PIPE WITH 3" BRASS CAP IN 10" CONCRETE  
CYLINDER

" Hat Section

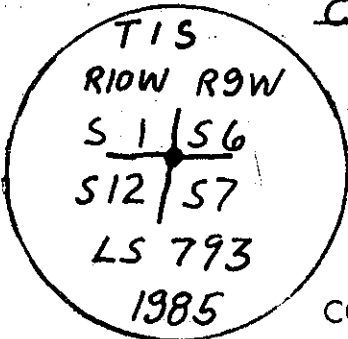

NEW ACCESSORY:

<u>PP# 2-01-10</u>	<u>S 60° W 49 35</u>	<u>Δ (SCRIBED)</u>
<u>PP# 2-01-09</u>	<u>S 54° E 33 15</u>	<u>Δ (SCRIBED)</u>
<u>SW COR STORAGE WAREHOUSE</u>	<u>N 54° W 25 32</u>	<u>NO MARKS</u>
<u>SE " " "</u>	<u>N 56° E 23 61</u>	<u>NO MARKS</u>

STORAGE WAREHOUSE IS OLD CHEESEFACTORY

COMMENTS: THIS CORNER IS LOCATED IN A NEW  
DRIVEWAY TO WAREHOUSE. THE OLD MONUMENT WAS DISTURBED  
BY DRIVEWAY CONSTRUCTION AND DISPLACED ± 0' WEST AND ± 0' 16" NORTH.  
BRASS CAP WAS RIPPED OFF OF OLD MONUMENT ± 15" DEEP IN DRIVEWAY.

IN THE PRESENCE OF: DAN MCNUTT ALDVORAK

DATE: 8-6-85

PHOTO#: \_\_\_\_\_

\* = County corner tag affixed.

TITLE \_\_\_\_\_