

TILLAMOOK COUNTY REWITNESS

#66

SEC. 6 T 2N R 9 W., WM.

HISTORICAL: GLO SG. CAUDLE 1881

Bk 10 Page 15	MAP F-41-27 1908	Page 5 & 83 GLO 2N9	Page 35 GLO 3N9
Bk 4 Page 82 WEA	MAP B-286 WEA 1880	MAP A-1027 JLC 1962	
Bk 1 Page 82 WEA	MAP B-364 WEA	MAP A-1103 RAM 1963	
MAP B-260 WEA 1923	MAP A-691 WEA 1950	MAP B-553 CGC 1967	
MAP B-194 1908	MAP B-387 RAM 1957	MAP B-515 JLC 1966	
		MAP A-2038 JLC 1970	

CONDITION

FOUND:

Gene	Field check 1967	6" Spr S 27° W	38 2	WEA Bk 4 Pg 82
Now 12"	1967	8" Hem S 42° E	27 8	" " "
Now 12"	1967	6" Hem N 40° E	29 2	
Now 24"	1967	18" Hem N 40° W	37 2	
Snag ± 12' high	1967	40" Hem S 71° E	76 85	OLD FACE OF BANK - did not expose GLO
			71 LKS	

COMMENTS:

REWITNESS

I SET

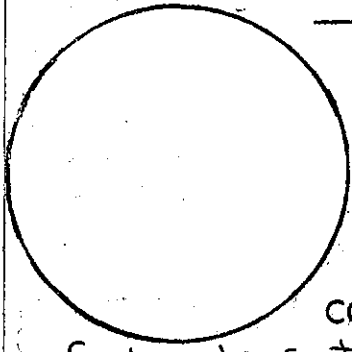

"x" "x" "x" N. 70° E feet 1 2
 06 " Hat Section S. E.

NEW ACCESSORY:

COMMENTS: Corner falls ± 15 feet easterly of top of bank cut of Road. Tied corner as shown on extra sheet, to Winslow survey (MAP A-2038) by AD, GU, & GA, in November 1970

IN THE PRESENCE OF:

Al Duncan
 Gale Arthur
 George Urrey

DATE: 1967/1970

PHOTO#:

12/10/70 [Signature]

TITLE C.S. GWA

* = County corner tag affixed.

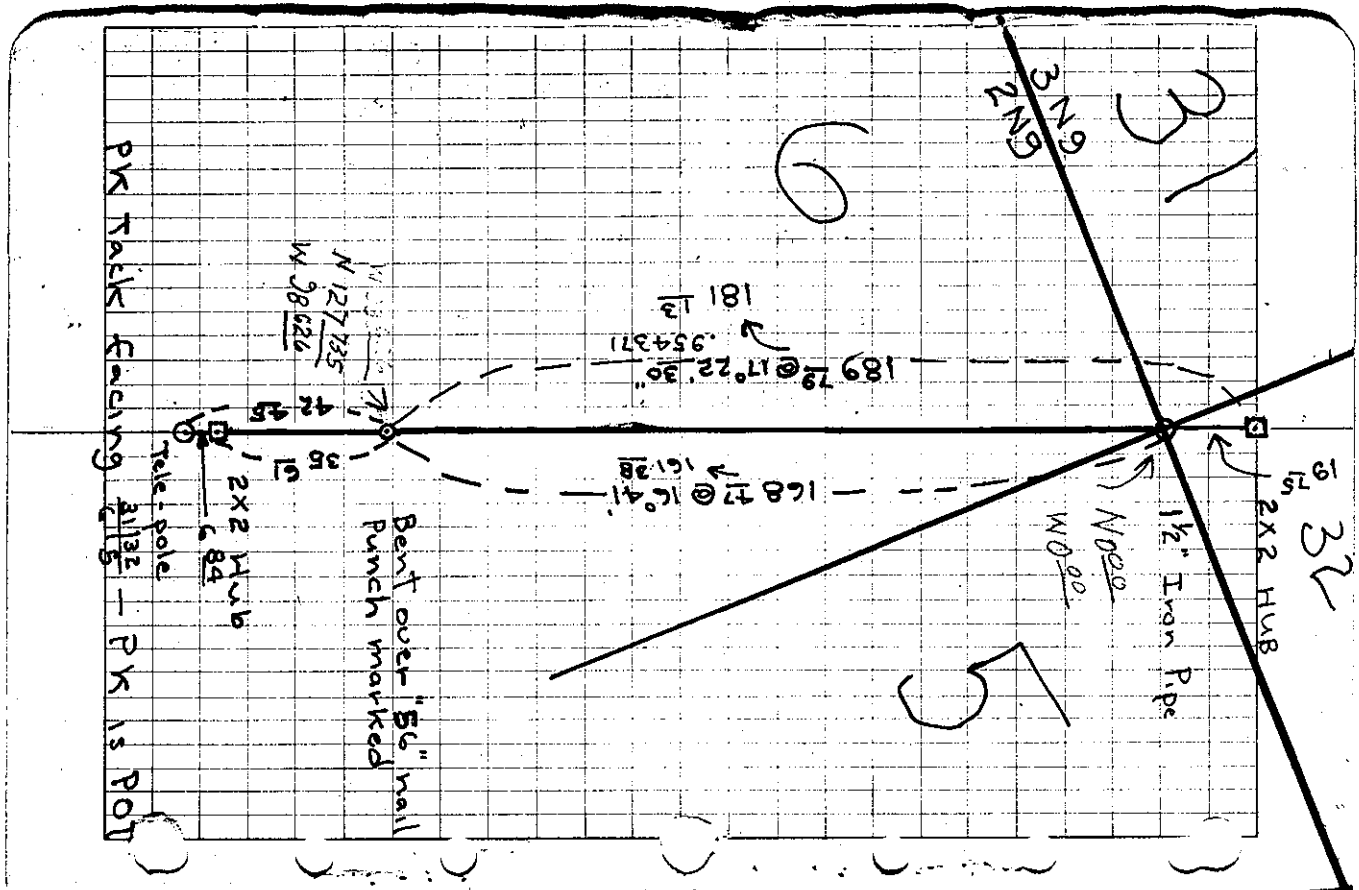
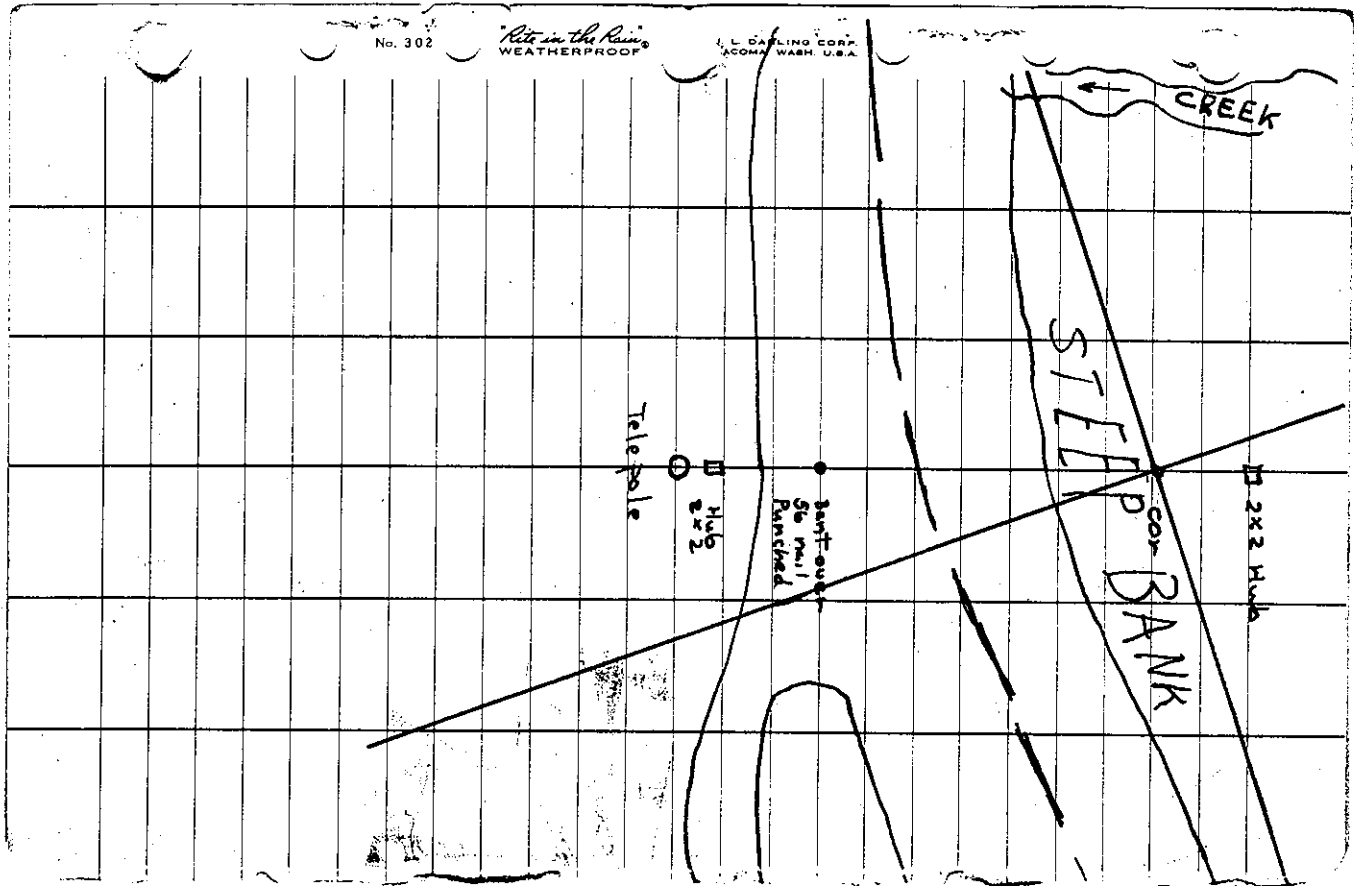

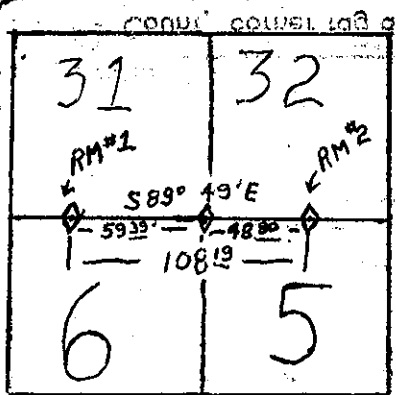

TILLAMOOK COUNTY REWITNESS

N.W. SEC. _____
 COR. _____ T _____ R _____ W., WM.
 S. E.

HISTORICAL:

CONDITION

FOUND:

COMMENTS:

REWITNESS

1 SET 2" IRON PIPES WITH 3" BRASS CAPS FOR REFERENCE MONUMENTS
 * 86" HAT SECTION BEARS WEST 12 1/2 FEET FROM RM#1
 * 86" HAT SECTION BEARS S. EAST 15 FEET FROM RM#2

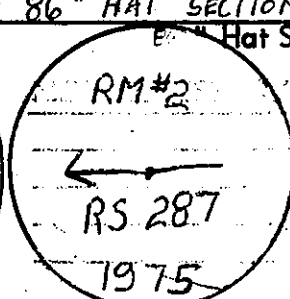
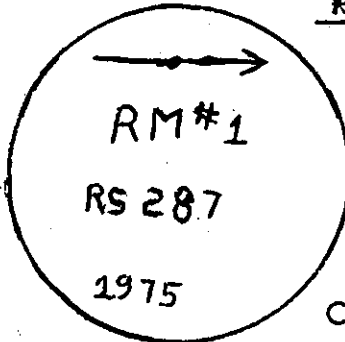

CAPS ENCASED IN CONCRETE

RM#1 IS FOUND IN DEEP SAND
ON ROAD SIDE (APPROXIMATELY 10
FEET EAST)

COMMENTS: THESE REFERENCE MONUMENTS WERE SET FROM
 HUB SYSTEM IN FIELD NOTES FOR GEO. P. WINSLOW SR, SEC 6 T2N R9W
 G. ARTHUR A. DUNCAN G. URREY

IN THE PRESENCE OF: GALE ARTHUR DAN MCNYTT
 KEVIN DUNN

DATE: 10-22-75

PHOTO#: 10/22/75

* = County corner tag affixed.

TITLE