

WEYERHAEUSER GOVT. CORNER VISITATION

SECTION 24 TOWNSHIP 2S RANGE 7W W.M. BLM ID# 620300
 COUNTY: TILLAMOOK CORNER WEST SIXTEENTH
 DATE 9/27/2016 X CONDITION REPORT RENEWED

PREVIOUS RENEWALS/SURVEYS, ETC.:

B2634, AND B-2916

MONUMENT (S) AND ACCESSORIES FOUND, CONDITION AND (ORIGIN)

- 3 3/4" BRASS CAP, FLUSH WITH THE GROUND. (B-2634)
 FOUND A 3/4" FIBERGLASS POST 1' NORTH OF MONUMENT
- 15" D.FIR, WITH A HEALED FACE AND YELLOW B.T. TAG, BEARS N59 3/4°W, 7.94' (B-2634)
 (12" DOUGLAS FIR, BEARS S42°13'03"E, 2.28' - B-2619)
- 14" D.FIR, WITH A HEALED FACE AND YELLOW B.T. TAG, BEARS S42 1/4°E, 2.28' (B-2634)
 (13" DOUGLAS FIR, BEARS N59°49'00"W, 7.94' - B-2916)

MONUMENT (S) SET (PROCEDURES AND DESCRIPTION)

NONE

NEW ACCESSORIES:

NONE

LOCATION & COMMENTS:

FROM THE INTERSECTION OF THE MURPHY GRADE ROAD, MURPHY CAMP ROAD, TOLL ROAD, AND HEAD-QUARTERS GRADE ROAD, GO SOUTHERLY ALONG THE HEADQUARTERS GRADE ROAD TO THE HEADQUARTERS GRADE ROAD GATE. FROM THE GATE, PROCEED APPROXIMATELY 1.2 MILES SOUTHERLY ALONG THE HEADQUARTERS GRADE ROAD TO WHERE THE ROAD TURNS EAST AND INTERSECTS THE SOUTH LINE OF SECTION 24. FOLLOW THE BLAZED LINE WESTERLY APPROXIMATELY 2100 FEET TO THE CORNER.

NOTES:

- ALL FACES WERE PAINTED BLUE, AS WAS A 6" BAND AROUND THE TREES.
- DISTANCES TO THE BEARING TREES WERE MEASURED WITH A 75' BUCKERS TAPE TO AN EXISTING NAIL AT THE SIDE CENTER.
- BEARINGS WERE COMPARED WITH A HAND COMPASS WITH THE DECLINATION SET AT 16°E.
- NEW 3" ALUMINUM NAILS WERE DRIVEN INTO THE EXISTING LOCATION POSTERS.

WITNESSES:

KENT R. INMAN
 ZACHARY K. INMAN

MONUMENT DETAIL:



INMAN SURVEYING, LLC
 1148 LISA CT NE
 KEIZER, OR 97303
 (541) 521-8311

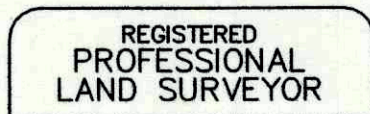
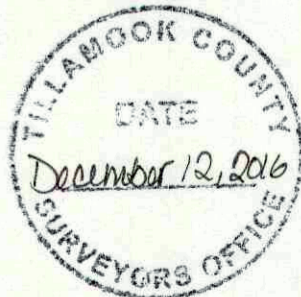

Kent Ryan Inman

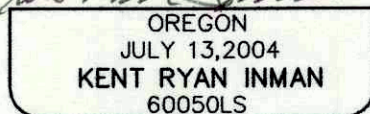

Expiration Date: 6/30/2017

SKETCH:



SCALE: 1" = 50'

