

LINCOLN COUNTY CORNER REPORT
CLOSING CORNER OF SECTIONS 23 AND 24, (06-09)
GCDB 0609600398
LINCOLN COUNTY GEODETIC CONTROL STATION 68COR
SHEET 1 OF 1

1908 MORRIS WYGANT GLO CONTRACT 758

DURING SURVEY OF SUBDIVISIONAL LINES, INTERSECT NORTH BOUNDARY OF SILETZ INDIAN RESERVATION, ALSO SOUTH BOUNDARY OF SECTION 14, 7.40 CHAINS (488.4') WEST OF CORNER OF SECTIONS 13 AND 14, WHICH IS A STONE, FIRMLY SET, MARKED AND WITNESSED AS DESCRIBED BY THE SURVEYOR GENERAL. I DESTROY ALL MARKS ON BEARING TREES (STONE NOT MARKED) RELATING TO SECTIONS 23 AND 24.

SET: FIR LIMB POST 3' LONG, 4" SQUARE IN THE GROUND FOR CLOSING CORNER TO SECTIONS 23 AND 24, MARKED "CC T6S R9W" ON SOUTH, "S24" ON EAST, AND "S23" ON WEST FACES, WITH 1 GROOVE ON EAST AND 5 GROOVES ON WEST FACES, FROM WHICH:

- 6" CRAB APPLE MARKED "T6S R9W S24 BT" BEARS S 8° E, 35 LINKS (23.1').
- 36" HEMLOCK MARKED "T6S R9W S23 BT" BEARS S 35° W, 103 LINKS (68.0').

1975 DAVE L. BOWDEN CS 6437

FOUND: ORIGINAL 36" HEMLOCK WITH SCRIBING "T6SR9W" VISIBLE BEARS S 35° E, 68.0' (= GLO).

SET: 1" STAINLESS STEEL PIPE AT RECORD BEARING AND DISTANCE FROM ORIGINAL SOUTHWEST BEARING TREE, WITH 2" BRASS CAP MARKED "SEC COR 14/23/24 T6S R9W 513", FROM WHICH:

NEW:

- 19" HEMLOCK SCRIBED "S24 BT" BEARS S 89°00' E, 51.9'.
- 18" HEMLOCK SCRIBED "S23 BT" BEARS S 80°30' W, 50.40'.
- CORNER SET ON SOUTH EDGE OF OLD EAST-WEST ROAD, AND 14' WEST OF 6' WIDE STREAM FLOWING N 30° W.

2009 LINCOLN COUNTY SURVEYOR'S OFFICE

FOUND: 1-1/4" OUTSIDE DIAMETER STAINLESS STEEL PIPE, 3' LONG, 1" LOOSELY IN GROUND, IN MOUND OF STONES, WITH 2" BRASS CAP MARKED "SEC COR 14/23/24 T6S R9W 513", FROM WHICH:

- ORIGINAL 33" ROTTEN HEMLOCK STUMP 6' TALL WITH ILLEGIBLE SCRIBING VISIBLE ON PARTIAL FACE AND SLIGHT OVERGROWTH AT TOP OF FACE BEARS S 35° W, 68.0' TO FACE (= GLO).
- 21" ROTTEN HEMLOCK SNAG 7' TALL WITH HEALED BLAZE AND "BEARING TREE DO NOT CUT" TAG BEARS S 89° E, 51.9' (= CS 6437 RECORD).
- 30" HEMLOCK WITH HEALED BLAZE BEARS S 80-1/2° W, 50.4' (= CS 6437 RECORD). FOUND "BEARING TREE DO NOT CUT" TAG ON GROUND ADJACENT TO TREE.
- STEEL T-POST BEARS NORTH, 3'.
- ORANGE-PAINTED LINE BLAZES ON 4 CRAB APPLE TRUNKS 23-40' SOUTH OF CORNER.

NEW:

- RESET PIPE IN FOUND LOCATION, ON TOP OF IMMOVABLE STONE, WITH CAP 1.6' ABOVE GRADE IN MOUND OF STONE WITH CONCRETE CORE.
- REATTACHED "BEARING TREE DO NOT CUT" TAG TO SOUTHWEST BEARING TREE.
- LINCOLN COUNTY SURVEY MARKER TAGS ON 1975 BEARING TREES.
- 5/8" X 30" IRON ROD WITH 2" ALUMINUM CAP AT GRADE, MARKED "LINCOLN COUNTY 68AZ 2009" BEARS S13°56'15" E, 292.52'. A CARSONITE POST WITH A LINCOLN COUNTY SURVEY MARKER TAG BEARS NORTH, 3'.

CONCLUSION THE PIPE FOUND IS THAT SET BY BOWDEN IN 1975 AND PERPETUATES THE ORIGINAL CLOSING CORNER SET BY WYGANT IN 1908. A CALCULATED TRUE CLOSING CORNER BASED ON 78COR AND 17COR FALLS 18.03' NORTH, IN A 6' WIDE STREAM FLOWING NORTHWEST. IT WAS NOT SET.

MEASUREMENTS WERE DONE WITH A LEICA TCA1105 TOTAL STATION, POCKET COMPASS AND STEEL TAPE. BEARINGS ARE GEODETIC, BASED UPON STARNET PROJECT 6-9.PRJ AND THE MAPPING ANGLE OF -2°18'07" AT THE SECTION CORNER.

WITNESSES:

PHIL LAMBERSON, CHAZ MALARKEY

LINCOLN COUNTY SURVEYOR'S OFFICE
880 NE 7TH ST.
NEWPORT, OREGON 97365
(541)-265-4147

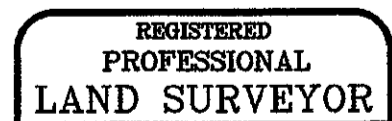
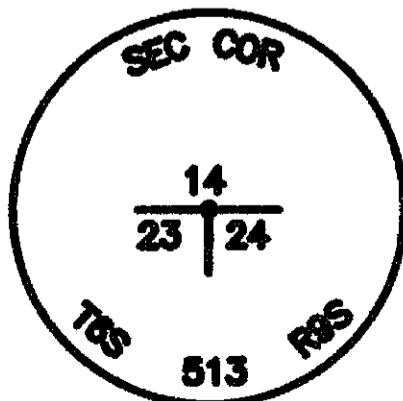

Tom Hamilton

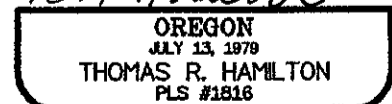

RENEWAL DATE: JUNE 30, 2009