

TILLAMOOK COUNTY SURVEYORS OFFICE  
COURTHOUSE, TILLAMOOK, OREGON 97141

SECTION CORNER COMMON TO SECTIONS 9, 10, 15, AND 16, TOWNSHIP 1  
NORTH, RANGE 10 WEST, WILLAMETTE MERIDIAN, TILLAMOOK COUNTY,  
OREGON.

I FOUND A 3" DIAMETER BRASS CAP IN GOOD CONDITION STAMPED AS SHOWN  
HEREON. I ENCASED THE MONUMENT IN A CONCRETE CYLINDER.

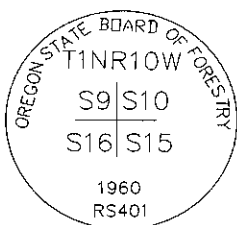

---

HISTORY OF FOUND MONUMENT

THIS MONUMENT WAS ORIGINALLY SET BY THE GENERAL LAND OFFICE BY C. HANDLEY IN JULY OF 1873. THE CORNER WAS THEN REESTABLISHED BY RICHARD A. MORRIS, L.S. 401 IN OCTOBER OF 1960 AND FILED IN BOOK 2, PAGE 460, TILLAMOOK COUNTY SURVEY RECORDS.

THE MONUMENT WAS FOUND AS DESCRIBED IN REWITNESS BOOK 2, PAGE 460, AND THE ACCESSORIES FOUND AND/OR SET AT THAT TIME TO NOW BE AS FOLLOWS:

REWITNESS BOOK 2, PAGE 460, A 12" DIAMETER HEMLOCK SCRIBED "T1NR10WS16BT" WHICH BEARS SOUTH 43° WEST 28.4'; 12-14-05 FOUND A 2.0' TALL ROTTEN STUMP AT RECORD POSITION, SCRIBING BARELY VISIBLE.

REWITNESS BOOK 2, PAGE 460, A 16" DIAMETER HEMLOCK SCRIBED "T1NR10WS15BT" WHICH BEARS SOUTH 19° EAST 11.5'; 12-14-05 FOUND A 20" DIAMETER, 10' TALL SNAG WITH HEALED FACE AT RECORD POSITION, NO SCRIBING VISIBLE.

REWITNESS BOOK 2, PAGE 460, AN 11" DIAMETER SPRUCE SCRIBED "T1NR10WS9BT" WHICH BEARS NORTH 73° WEST 25.0'; 12-14-05 BEARING TREE IS NOW GONE.

REWITNESS BOOK 2, PAGE 460, A 25" DIAMETER HEMLOCK SCRIBED "T1NR10WS10BTRS401" WHICH BEARS NORTH 2° EAST 21.5'; 12-14-05 FOUND A ROTTEN STUMP WITH SCRIBING VISIBLE AT RECORD POSITION.

REWITNESS BOOK 2, PAGE 460, SET A 4" X 4" X 52" WHITE PAINTED CEDAR POST 1.0' NORTHWEST OF MONUMENT; 12-14-05 FOUND A ROTTEN WHITE POST LYING ON THE GROUND NEXT TO THE MONUMENT.

REWITNESS BOOK 2, PAGE 460, SET AN OREGON STATE BOARD OF FORESTRY METAL LOCATION POSTER ON 16" DIAMETER HEMLOCK BEARING TREE; 12-14-05 METAL POSTER TAG IS NOW GONE.

---

SURVEYS AND REWITNESSES OF RECORD

G.L.O. Contract Surveyed by C. Handley, July 10, 1873.  
G.L.O. BOOK 1N&2N, PAGE 43, Tillamook County Survey Records.

REWITNESS BOOK 2, PAGE 460, Richard A. Morris, L.S. 401, October 24, 1960  
MAP A-1206, Richard A. Morris, L.S. 401, September 1964  
MAP A-1673, Harold J. Russell, L.S. 707, January 1968  
MAP B-437, Richard A. Morris, L.S. 401, April 23, 1959  
MAP B-460, John L. Carlich, L.S. 287, Summer 1961

---

#### NEW ACCESSORIES

\*8" DIAMETER DOUGLAS FIR TREE WHICH BEARS NORTH 71° EAST 25.4' SCRIBED "TINR10WS10BT". DISTANCE WAS MEASURED TO A BRASS WASHER STAMPED "T.C. SURV" NAILED TO THE FACE BETWEEN THE SCRIBED 'B' & 'T'.

\*34" DIAMETER HEMLOCK TREE WHICH BEARS SOUTH 56° EAST 15.45' SCRIBED "TINR10WS15BT". DISTANCE WAS MEASURED TO A BRASS WASHER STAMPED "T.C. SURV" NAILED TO THE FACE BETWEEN THE SCRIBED 'B' & 'T'.

\*9" DIAMETER HEMLOCK TREE WHICH BEARS NORTH 78° WEST 26.05' SCRIBED "TINR10WS9BT". DISTANCE WAS MEASURED TO A BRASS WASHER STAMPED "T.C. SURV" NAILED TO THE FACE BETWEEN THE SCRIBED 'B' & 'T'.

\*12" DIAMETER DOUGLAS FIR TREE WHICH BEARS SOUTH 53° WEST 34.3' SCRIBED "T1NR10WS16BT". DISTANCE WAS MEASURED TO A BRASS WASHER STAMPED "T.C. SURV" NAILED TO THE FACE BETWEEN THE SCRIBED 'B' & 'T'.

BASIS OF BEARINGS FOR BEARING TREES IS MAGNETIC.

\*SET 72" LIGHT HAT SECTION POST SOUTH 3.0' FROM MONUMENT.

SET STEEL FENCE POST WEST 3.0' FROM MONUMENT.

\* INDICATES TILLAMOOK COUNTY YELLOW METAL LOCATION POSTER ATTACHED.

---

#### LOCATION OF MONUMENT

THIS SECTION CORNER IS LOCATED IN A STEEP CANYON APPROXIMATELY 300' NORTHEAST OF THE END OF A LOGGING ROAD.

NOTE: NO ATTEMPT WAS MADE TO VERIFY THE POSITION OF THIS MOMUMENT FROM THE INFORMATION CONTAINED IN REWITNESS BOOK 2, PAGE 460. THE INTENT OF THIS REWITNESS/RESTORATION IS TO PERPETUATE THE POSITION AS PREVIOUSLY ESTABLISHED BY SAID REWITNESS.

IN THE PRESENCE OF, AND REWITNESSED BY DANNY R. MCNUTT, TILLAMOOK COUNTY SURVEYOR AND JOE JENSEN, SURVEY SUPERVISOR, TILLAMOOK COUNTY SURVEYOR'S OFFICE.

---

DECEMBER 14, 2005

TITLE:

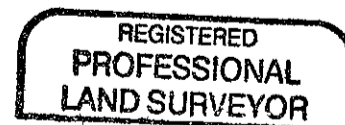
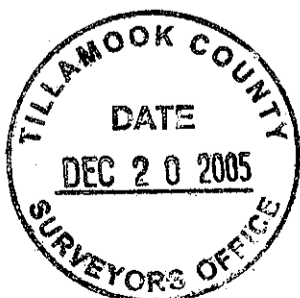

*Danny R. McNutt C.S.*

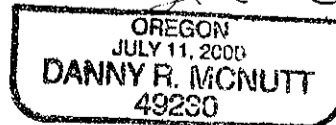

RENEWAL12-31-06