

TILLAMOOK COUNTY SURVEYORS OFFICE  
COURTHOUSE, TILLAMOOK, OREGON 97141

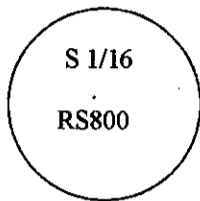

S 1/16 CORNER COMMON SECTIONS 11 & 12 T.4S;R.7W;W.M.

I FOUND A 3/4" IRON PIPE WITH A 1 1/4" BRASS CAP FLUSH WITH  
THE GROUND.  
I ENCASED THE FOUND MONUMENT IN AN IRREGULAR MASS OF CONCRETE.

HISTORY OF FOUND MONUMENT

I FOUND THIS MONUMENT TO BE AS DESCRIBED IN T.C.S. MAP #B-654 THE REFERENCES SET AT  
THAT TIME TO NOW BE AS FOLLOWS:

11" FIR N.9°E. 25.4 FEET; FOUND, AT POSITION, NOW AN 11" STUMP, 3' TALL, FACE OPEN WITH  
SCRIBING "S1/16S12BT" VISIBLE, AND TIN NAILED TO THE TOP, 25.04' TO FACE.

19" FIR N.55°W. 38.0 FEET; FOUND, AT POSITION, NOW A 19" STUMP, 5' TALL, FACE OPEN WITH  
SCRIBING "S1/16S11BT" VISIBLE, AND TIN NAILED TO THE TOP, 37.70' TO FACE.

SURVEY OF RECORD

B-654

NOVEMBER 1973

JAMES B. IREMONGER JR. RS 800

NEW ACCESSORIES

\*10" FIR N.64°E. 22.35' SCRIBED "S1/16S11BTCS". DISTANCE WAS MEASURED TO A T.C.S. BRASS  
WASHER WITH NAIL IN THE FACE BETWEEN THE SCRIBED "B" & "T".

\*10" FIR S.30°W. 2.85' SCRIBED "S1/16S12BTCS". DISTANCE WAS MEASURED TO A T.C.S. BRASS  
WASHER WITH NAIL IN THE FACE BETWEEN THE SCRIBED "B" & "T".

\*72" LIGHT HAT SECTION POST NORTH 1.5'.

LOCATION OF MONUMENT

THIS CORNER IS LOCATED APPROXIMATELY 150 FEET SOUTHERLY OF BALD MOUNTAIN ACCESS ROAD  
IN AN AREA REPLANTED WITH FIR. THIS CORNER WAS RESTORED FOR THE HISTORICAL VALUE ONLY, NO  
MEASUREMENTS WERE TAKEN TO CONFIRM THE POSITION.

IN THE PRESENCE OF JOE JENSEN AND DAN MCNUTT

MAY 5, 2004

TITLE:

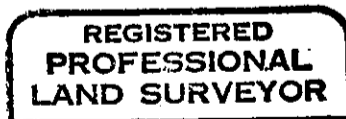
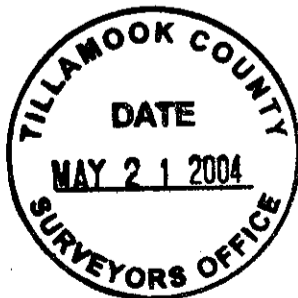

*Allan E. Duncan, C.S.*

