

OREGON CORNER RESTORATION FORM

Township 3 North Range 10 West Sections 11 & 14
 County: Tillamook Date: 3/15/98

Corner Designation: Property corner X Referenced Out
 By record 591.73 feet easterly of
 the SW corner of Section 11

Previous Renewals/Surveys, etc. This monument was set by Tillamook County Surveyor Al Duncan on County Survey #B-782, dated 1977.

Monument Found: (Condition and Source)
 Found Duncan's corner tree (10" Hemlock for the corner), now a 3-foot high 10" snag, with the top windthrown and the stump in place.

Accessories Found:
 Found 5/8" iron rod with aluminum cap set as a reference to the corner tree (N51W, 2.01').
 - Found galvanized 4' high steel highway style U post and tag approximately 1' West of corner.

Monument Detail

Sketch

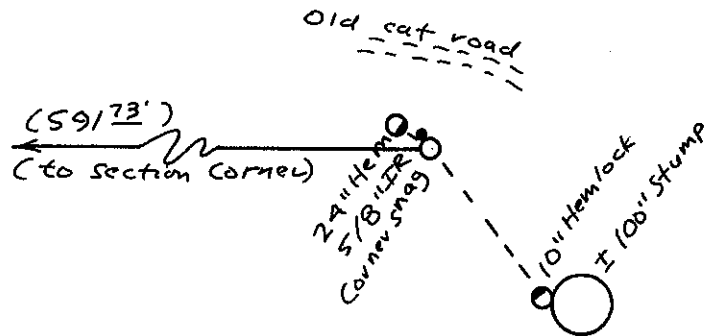

Monument Set (Procedure and Description) None.

New Accessories

- Set 10" dbh Hemlock, scribed PC BT, S36E, 37.7" to tag in low face, 38.8' to center of tree base, this new 10" BT is at the WNW edge of an approx 100" stump.
- Set 24" dbh hemlock, scribed PC BT, N55W, 8.4' to tag in low face, 9.9' to center of tree base

Note: New BT's and the TCS tree were painted with blue tree marking paint on faces and with a ring of blue paint. New BT's have a 3/4" brass tag attached with a hub tack to lower part of low face, tags are marked "OR LS 2168, WA LS 21392". New BT's also have a Willamette Ind. yellow BT tag.

Location and Comments
 Recent clearcut is South and West.

Hand Compass Declination: 21E

An old East-West cat trail is 20' North.

Firm/Agency
 Willamette Industries
 PO Box 998, Seaside, OR

Party Chief and Notes
 Andy Blachly
 No other witnesses

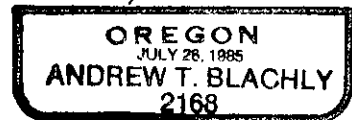
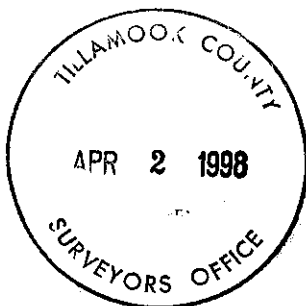

Renews 12/31/99