

TILLAMOOK COUNTY SURVEYORS OFFICE  
201 LAUREL AVENUE  
TILLAMOOK, OREGON 97141

1/4 CORNER SECTION 28 & 33, T.1S.,R.10W.,W.M.

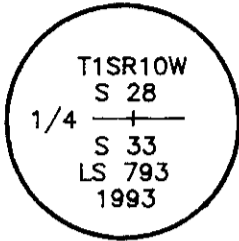

I set a 1 1/2" iron pipe with a 3" Tillamook County Surveyors Brass cap in a 10" concrete cylinder at the original bearing and distance stated in the original notes from the found SE bearing tree shown below.

**History of found monument**

This Corner has no record of ever being found until now. The original evidence used to position this corner is as follows:

- (G.L.O.) Set post 4' long, 4" in diam., 2 ft. deep, for corner, mkd 1/4 S on North face; (Now gone).
- (G.L.O.) 30" hemlock S.55°W 25 lks; (Now gone)
- (G.L.O.) \*72" spruce S.71°E 44 lks; (Found, Now a 96" spruce stump 10' high S71°E 44 lks. partial scribe marks "1/4S BT" visible, 10" deep in chopped out face).

This is the evidence used to position this corner.

**New Accessory**

- \*8" Spruce S.71°E. 14.98', scribed 1/4S33CSBT, the distance was measured to a finish nail with a Brass Washer in the face between the scribed "B" & "T".
  - \*5" Hemlock S.13°E. 13.99', scribed 1/4SBT, the distance was measured to a finish nail with a Brass Washer in the face between the scribed "B" & "T".
  - \*72" light hat section post West 1.5'.
  - \*72" light hat section post ±East 450' at the top of a cut bank (West side road).
- \* = Tillamook County yellow metal location poster attached.  
Brass washers are stamped "TILL CO. SURVEY".

**Location of Monument**

This corner is located on the East side of a small swampy area, ± 450' West of a paved road leading to the County Quarry, and 230' West of a small creek, course ± South, (G.L.O. original call 3.49 chains). Line crosses ± 1.4 miles wly from the Netarts Highway on the road leading to the county quarry.

In the presence of Al Dvorak and Dan McNutt

July 7, 1993

Title:

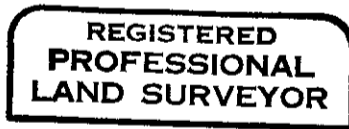
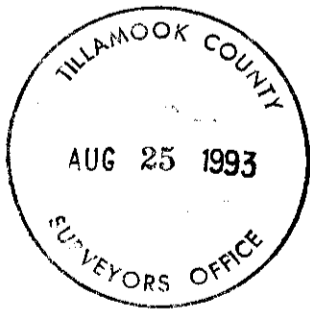

*Allan E. Duncan, C.S.*

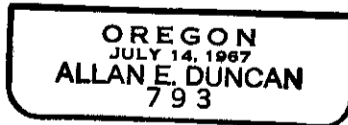

RENEWAL DATE  
12-31-93