

TILLAMOOK COUNTY SURVEYORS OFFICE
COURT HOUSE, TILLAMOOK, OREGON 97141

NW 1/16 CORNER SECTION 23, T.1N., R.10W., W.M.

NW 1/16 I found a 1 1/2" iron pipe with a 3" Oregon State
+ Board of Forestry Bronze Cap, (see T.C.S. Map
S 23 #B-419).
1959 I encased the found Iron Pipe and Bronze Cap in a
RS 401 10" concrete cylinder.

History of found monument

I found this monument to be as described on said T.C.S. Map and the references set at that time to now be as follows:

(Map #B-419) 10" spruce N.51 1/4°W. 120.0'; (Found, now a 28" stump 3' high, face healed).

(Map #B-419) 6" alder N.9 1/2°W. 13.6'; (Found, now down and rotten O.S.B.F. yellow metal location poster attached).

Found white cedar post broken off and laying alongside of corner position.

New Accessory

*72" light hat section post North 1.5'.

*15" Spruce S.23°W. 21.05', scribed "NW1/16S23BT". The distance was measured to a nail with brass washer in the face between the B & T.

*9" Hemlock N.41°W. 32.26', scribed "NW1/16S23BT". The distance was measured to a nail with brass washer in the face between the B & T.

*indicates Tillamook County Surveyors yellow metal location poster attached.

Surveys and Rewitnesses of record

B-419	12-31-59	Richard A. Morris	RS 401
Rewitness Book 2 page 431	12-31-59	Richard A Morris	RS 401
A-942	1961	Richard A. Morris	RS 401
B-901	Apr. 1980	C. Wayne Cook	LS 1098

Location of Monument

This corner is located approximately 50' Northerly of a gravel driveway, approximately 300' North of a substation, on the Southerly slope.

In the presence of Al Dvorak and Dan McNutt

May 20, 1992

Title

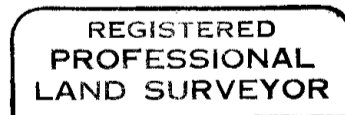

Allan E. Duncan, C.S.

