

TILLAMOOK COUNTY SURVEYORS OFFICE  
COURTHOUSE, TILLAMOOK, OREGON 97141

NW 1/16 CORNER SECTION 22 T.2S., R.9W., W.M.

NW 1/16            I found a 1 1/2" iron pipe with a 3" O.S.B.F. Brass  
S . 22            Cap (see T.C.S. Map #A-965). I encased the found  
1961               monument in concrete.  
RS 401

-----  
History of found monument

I found this monument to be as described in said T.C.S. Map and the references set at that time to now be as follows:

14" fir N.26 E. 10.6'; (Found, now 17" fir stump with healed face and rusty yellow metal location poster attached).

15" fir S.10 1/2 W. 22.8; (Found, now an 18" fir stump with healed over face).

-----  
Surveys and Rewitnesses of record

A-965                    October 1961                    Richard A. Morris    RS 401

-----  
New Accessories

15" diameter treated gate post S.32 E. 20.49' to a finish nail with a T.C.S. brass washer in the top center of the post.

\*84" light hat section post 2.2' North.

\*indicates yellow metal Tillamook County Surveyors location poster attached.

-----  
Location of Monument

This corner is located in the approximately 2' South of an E-W fence line and 12' West of a fence line, course South, on the North side of an old cat road.

-----  
In the presence of Al Dvorak and Dan McNutt

July 29, 1991

Title:

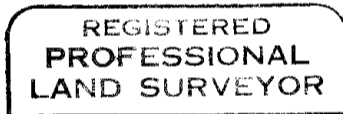

*Allan E. Duncan, C.S.*

