

TILLAMOOK COUNTY SURVEYORS OFFICE
COURT HOUSE, TILLAMOOK, OREGON 97141

1/4 CORNER COMMON SECTIONS 10 & 15 T.1N., R.10W., W.M.

1 S10 I found a 1 1/2" iron pipe with a 3" Oregon State
/ ----+---- Board of Forestry Bronze Cap (see T.C.S. Rewitness
4 S15 Book 2 at Page 446). I encased the found I.P. in a
1960 10" concrete cylinder.
RS 401

History of found monument

I found this monument to be as described on said T.C.S. Rewitness and the references found and/or set at that time to now be as follows:

Original 40" hemlock S.20°E. 17 lks., reported on above as a 48" hemlock stub 2' high face and scribes rotted away; (Now gone).

Original 36" hemlock N.10°W. 30 lks., reported on above as N.10°W. 33 lks. a 37" uproot backcast of scribes "BT" visible, both faces rotted away, roots and root hole in place; (Found, now a rotten pile of wood, unidentifiable).

(Book 2 Page 446) 12" Hemlock N.55 1/2°E. 16.0'; (Found, now a 12" stub 3' tall, rotten, scribing visible on partially healed face).

(Book 2 Page 446) 16" Hemlock S.30 1/2°E. 14.4'; (Found, now a 21" rotten stump 5' tall, face overgrown).

(Book 2 Page 446) 4"X 4"X 48" white painted cedar post 1.0' NE; (Found, rotted off).

New Accessory

*72" light hat section post North 1.6'.

*indicates Tillamook County Surveyors yellow metal location poster attached.

Surveys and Rewitnesses of record

B-437	9-1964	Richard A. Morris	RS 401
Rewitness Book 2 page 446	12-02-60	Richard A Morris	RS 401
A-1206	9-1964	Richard A. Morris	RS 401
G.L.O. Book 1N10 Page 43	7-11-1873		

Location of Monument

This corner is located approximately 50' Westerly of a gravel logging road in small replanted trees. No trees of sufficient size for bearing trees at this time.

In the presence of Al Dvorak and Dan McNutt

June 11, 1991

Title

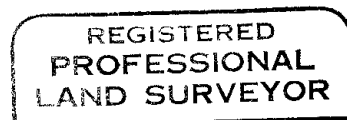
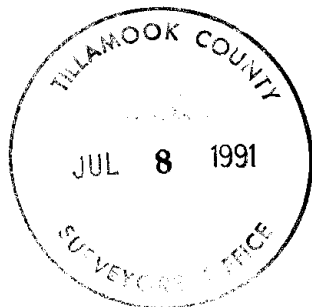

Allan E. Duncan, C.S.

