

TILLAMOOK COUNTY SURVEYORS OFFICE
COURT HOUSE, TILLAMOOK OREGON 97141

GOVERNMENT LOT CORNER 15 & 16 IN SECTION 18 T.5S., R.10W., W.M.
[CEE 1/64]

GVMT I found a 12"X 8"X 6" stone marked "XXXII". Part of
LOTS first X was chipped off, but the rest of the marks
15 | 16 were very plain. (See T.C.S. Map #B-668). I replaced
----+---- the found stone with a 3" Tillamook County Surveyors
| brass cap on a 1 1/2" iron pipe in a 10" concrete
1991 cylinder I layed the found stone on the easterly side
of the new monument.

History of found monument

I found this monument to be as described on T.C.S. Map #B-668 and
the references found and/or set at that time to now be as follows:

(Original) 17"X 9"X 6" stone [corner monument, see T.C.S. Book 5S10 page
43]; (Found now 12"X 8" X 6" stone part chipped off as described above).
Hayes "E" Page 119 called this stone 30"X 24"X 14". I question this call
as his chaining call of 20.27 chains from the 1/16 would put him at the
East 1/4 not at the south corner of lots 15 & 16.

(Hayes "E" Page 119) 4" alder N.85 W. 116 links; (Now gone).

(Map B-668) 32" spruce N.36 W. 7.5'; (Found, now 53" rotten stump 6' high
partially uprooted N.36 W. 6.5' Scribe marks "BT 1/32 S #287" visible on
Southerly root flair).

(Map B-668) 72" spruce S.13 E. 83.0' S.D.. (Found now 78" low cut stump
S.13 E. 79' horizontal. Scribe marks "BT 1/32 S #287" visible on
partially healed face. This stump is located on the Southerly side of old,
grown over, road grade).

New Accessory

*13" spruce S.70 E. 70.59'. The distance is measured to a nail with a
T.C.S. brass washer in the face between the B & T.

*6" alder N.43 E. 5.89'. The distance is measured to a nail with a T.C.S.
brass washer between the B & T.

*72" light hat section post North 1.5'.

*indicates Tillamook County Surveyors yellow metal location poster
attached.

Surveys and Rewitnesses of record

B-668	Summer 1957	John L. Carlich	LS 287
field notebook Hayes "E" page 119	1887	R.R. Hayes	
Rewitness Book 10 page 49	5-6-1887	R.R. Hayes	

Monument Location

This monument is located approximately 75' Northerly of an old grown
over logging road, approximately 50' Southerly of the top of a spur ridge
(course east), and approximately 250' west of a gravel logging road.

In the presence of Dan McNutt and Al Dvorak

May 1, 1991

Title:

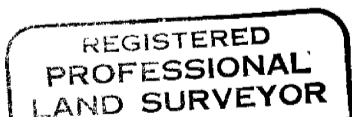

Allan E. Duncan, C.S.

