

TILLAMOOK COUNTY SURVEYORS OFFICE

1/4 CORNER COMMON TO SECTIONS 2 AND 1 T.1N., R.10W., W.M.

T1NR10W I found a 5" diameter spruce post scribed 1/4 S (no
 1/4 record). I replaced the found post with a 1 1/2" iron
 | pipe and 3" Tillamook County Surveyors brass cap in
 S2+S1 a 10" concrete cylinder. I layed the found post
 | alongside the new monument.
 1991

 History of found monument

The said post was used by the Oregon State Board of Forestry for subdivision of the sections 1 and 2 in 1959 (See T.C.S. Map #B-437) and on several surveys thereafter. I also found 2 unrecorded bearing trees, which appear to be approximately 40 to 50 years old judging from a ring count on the SE B.T., and are located as follows:

*24" hemlock S.85 E. 16.94'; (I partially opened the face to expose the scribing and get an approximate age of the unrecorded rewitness. I set a T.C.S. brass washer with finish nail in the face. The distance was measured to the said brass washer).

*19" hemlock snag 25'high N.85 W. 19.50'; (Found portions of scribe marks on rotten face).

reset found 1" aluminum pipe N.11 W. 1.92'. (reported on map #A-3209).

reset found 1" aluminum pipe S.78 W. 1.80'. (reported on map #A-3209).

 New Accessory

*72" hat section post North 1.5'.

*10" hemlock N.54 W. 15.40' scribed 1/4 S2 B.T

All distances to new Bearing trees are measured to a finish nail with a Tillamook County Surveyors brass washer in the face.

*indicates Tillamook County Surveyors yellow metal location poster attached.

 Surveys and Rewitnesses of record

B-437	1960	Richard A. Morris	RS 401
A-3361	7-77	John L. Carlich	RS 287
A-3209	6-77	Colin H. Handforth	PE 3510
A-3213	5-77	Colin H. Handforth	PE 3510
A-4216	6-77	Colin H. Handforth	PE 3510
A-5314	11-7-85	Ronald G. Larson	LS 2102

 Location of Monument

This monument is located on a steep SWesterly slope approximately 50' South of a creek, and 25' West of a cutting line.

In the presence of Al Dvorak and Dan McNutt

February 26, 1991

Title

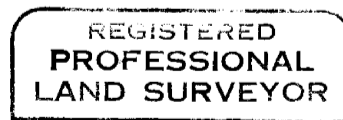
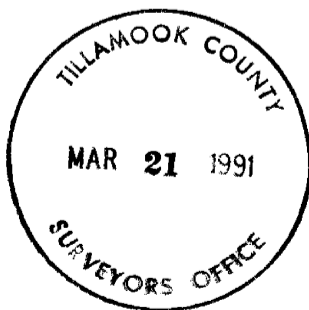

Allan E. Duncan, C.S.

