

TILLAMOOK COUNTY SURVEYORS OFFICE

Initial Point
Bayley Park Addition to Garibaldi Cove
In Section 21 T.1N.,R.10W.,W.M.

INT PT
BAYLEY
PARK. ADD
RS 793
1981

I found a 3" Tillamook County Surveyors Brass cap on a 5/8" iron rod inside of 3/4" iron pipe, 1 1/2" deep, set in concrete. I set a 10" cast monument case around the found monument and encased in concrete.

History of Found Monument

I found this monument to be as described in Tillamook County Surveyors re-witness card #45 and the references set at that time to now be as described below:

SF bolt in the top of a fire hydrant S.45*W. 37.93'; (Found O.K.)

A finish nail in a power pole S.38*E. 32.90'; (Now S.42*E. 32.93' to a finish nail in an axe blaze facing the monument, 33.44' to a cup tack in a scribed triangle on the Easterly side of the pole. The pole number is 216643.

For original plat see Tillamook County Surveyors map #C-89.

Location of Monument

This initial point is located at the centerline intersection of 3rd street (Large Street) and Cypress Avenue (Hemlock Avenue) in the City of Garibaldi.

In the presence of Dan McNutt & Al Dvorak

November 15, 1990

Title:

Int. Pt. Russell Hawkins Second Add

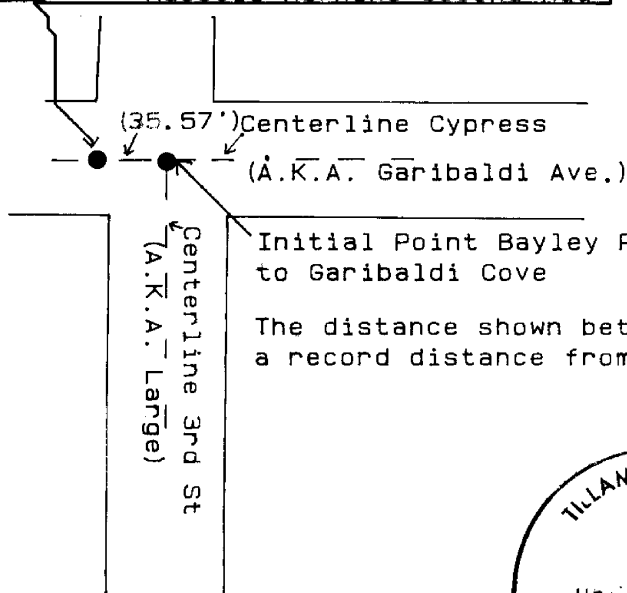

Initial Point Bayley Park Addition to Garibaldi Cove

The distance shown between the two initial points is a record distance from Subdivision monument notes.

REGISTERED
PROFESSIONAL
LAND SURVEYOR

Allan E. Duncan

OREGON
JULY 14, 1967
ALLAN E. DUNCAN
793

