

TILLAMOOK COUNTY SURVEYORS OFFICE

Initial Point
Classic Ridge Beach
In Section 29 T.3N.,R.10W.,W.M.



I found a 2" iron pipe with a wooden plug and nail approximately 24" below the surface of the ground. I set a 1 1/2" iron pipe with a 3" brass cap above the found iron pipe, and encased in a 10" concrete cylinder.

History of Found Monument

The found monument reset by the sanitary authority after sewer construction in about 1970, (see Tillamook County Surveyors map #B-726, Also see map #A-5960).

I found a 3/4" iron pipe with a yellow cap inscribed "PE 3510" Easterly 0.21', (See Tillamook County Surveyors Map #B-726).

I found a 3/4" iron pipe 0.7' Easterly, (Unknown Origin).

I found a steel fence post alongside of the corner, (I reset approximately 1.5' Easterly).

New Accessory

72" light hat section post 1.5' North.

Location of Monument

This corner is located approximately 325' East of the East end of the as built Dorcas Lane (32 street), at the East end of the street as platted.

In the presence of Dan McNutt & Al Dvorak

October 16, 1990

Title:

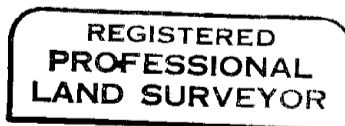

Allan E. Duncan, C.S.

