

TILLAMOOK COUNTY SURVEYORS OFFICE

CW 1/16 Corner of section 16 T.1S.,R.9W.,W.M.

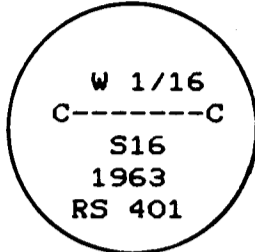

I found the O.S.B.F. 1 1/2" iron pipe with 3" bronze cap set in 1963, (See Tillamook County Surveyors map #A-1099), I encased in a 10" concrete cylinder.

History of found monument

This corner was originally set for Oregon State Board of Forestry, by Richard A. Morris RS 401 in 1963, on the above said map, and reset by same in 1976 at the correct location as shown on said map. The accessories set in 1976 are now as follows:

14" Spruce S.9*W. 102.9'; (now 22", face overgrown).

55" Spruce N.67*W. 45.3'; (now 63", face overgrown, O.S.B.F. yellow metal location poster attached).

56" Spruce S.55*E. 8.1'; (now 60" stump 5' high O.S.B.F. yellow metal location poster attached).

White Cedar Post NW 1.0'; (found).

New Accessories

*72" light hat section post 1.5' North

*indicates Tillamook County Surveyors yellow metal location poster attached.

Monument location

This corner is located approximately 100' East of a dirt logging road at the NW corner of a recent clear-cut.

In the presence of Dan McNutt and Al Dvorak

June 1990

Title:

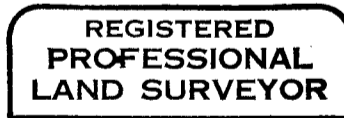

Allan E. Duncan, C.S.

