

TILLAMOOK COUNTY SURVEYORS OFFICE

Initial Points of the I.O.O.F. Cemetery  
in  
The NW 1/4 of The NE 1/4 of Section 14 T.45.,R.10W.,W.M.

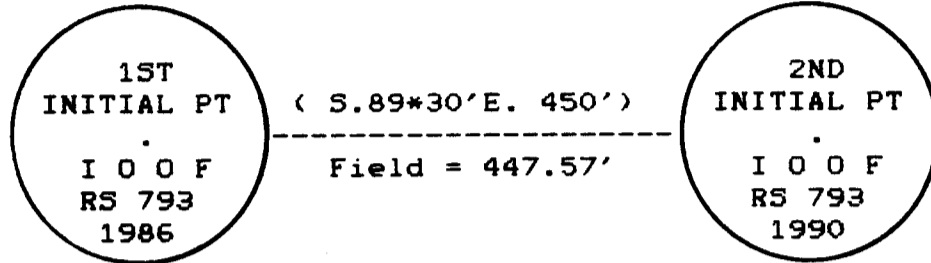

I set a 1 1/2" iron pipe with 3" Tillamook County Surveyors brass cap in 10" concrete cylinder at the position of a found 6"x9"x22" stone marked "X" as called for in Tillamook County Surveyors Survey book S3 at page 400.

I set a 1 1/2" iron pipe with 3" Tillamook County Surveyors brass cap in 10" concrete cylinder at the position of a found 6"x9"x17" stone marked "X" as called for in Tillamook County Surveyors Survey book S3 at page 400.

COMMENTS

I also set an 84" hat section post in a N-S-E fence corner, 3.25' south of the second initial point. I laid the found stones alongside of the monuments.

In the presence of Dan McNutt and Al Dvorak

March 1990

Title

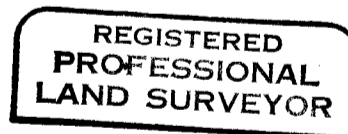

*Allan E. Duncan, C.S.*

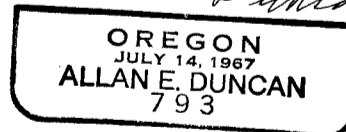

*3/29/90*