

RESTORED CORNER FOR STATE OF OREGON - DEPARTMENT OF FORESTRY

One quarter corner common to Sections 1 and 6, T3S, R6&7W, W.M., Tillamook County, Oregon.

ORIGINAL by Henry Meldrum, May 21, 1873.

15"x12"x5" stone; missing, point falls in old cat road.

RESTORATION by George F. Rigby, B.L.M. Cadastral Engineer, 1940, Group #240.

1"x36" iron post with brass cap, 28" in ground with original stone at base; iron post found out of place, buried lengthwise in edge of old cat road.

Raised a mound of stone with a 4 ft. base, 2 1/2 ft. high West of corner; missing, point falls in old cat road. Stream 1 lk. wide bears S00 09W 99 lks., course NW; in place.

RESTORED June 14, 1988

Var. 21 1/2 E

Reset above pipe 34" in ground, in edge of old cat road, added marks "1988 LS1998", and from which a:

23" Fir bears N73E 10.7 ft. to face; scribed 1/4S6BT.
21" Fir bears N15W 32.4 ft. to face; scribed 1/4S1BT.

4"x4"x60" white painted Cedar post bears N55W 3.5 ft. from corner pipe.

Metal location poster on BTs.

1956 B.L.M. metal location poster on 39" Fir stump bears S70E 10.0 ft. 3/4" brass washer marked "LS1998" nailed to face of BTs.

Present and witnessed by David B. Buchholz and Clifford R. Foster.

Restored by

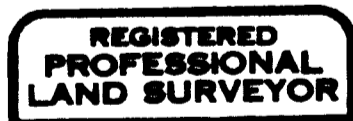

Anthony J. Klosterman

