

RESTORED CORNER FOR STATE OF OREGON - DEPARTMENT OF FORESTRY

Line tree corner common to Sections 1 and 2, T1S, R8W, W.M.,
Tillamook County, Oregon.

ORIGINAL by Frank H. Sharp, August 21, 1893.

70" Fir bears $S00^{\circ}01'E$ 6.00 chains from the one quarter
corner common to sections 1 and 2; now a 61" stump, in place,
2 notches on South side, exposed lower backcast notch, upper
notch grown over.

RESTORED

Var. $21\ 1/2^{\circ}E$

Set 1"x48" galvanized iron pipe with yellow plastic cap marked
"LS1998", 44 inches into center of stump, and from which a:

27" Fir bears $N88^{\circ}E$ 39.7 ft. to face; scribed WPS1BT.
10" Fir bears $N20^{\circ}W$ 64.9 ft. to face; scribed WPS2BT.

Metal location posters on BT's.

3/4" brass washer marked "LS1998" nailed to face of BTs.

Present and witnessed by David B. Buchholz and Clifford R. Foster.

Restored July 10, 1987 by

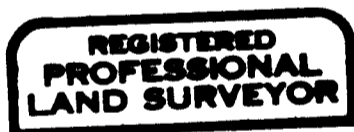

Anthony J. Klosterman

