

RESTORED CORNER FOR STATE OF OREGON - DEPARTMENT OF FORESTRY

Line tree corner common to Sections 14 and 23, T1N, R7W, W.M.,
Tillamook County, Oregon.

ORIGINAL by Henry Meldrum, September 15, 1884-

30" Cedar bears West 22.80 chains from the section corner
common to 13, 14, 23, and 24; now a 48" stump, in place,
exposed 2 backcast notches in cutoff portion of tree lying
alongside.

RESTORED

Var. 21 1/2° E

Set 5/8"x36" steel re-bar with yellow plastic cap marked
"LS 1998", 34 inches into center of hollow stump, and from
which a:

12" Fir bears S28°W 16.5 ft. to face; scribed WPS23BT.
11" Fir bears N62°E 12.8 ft. to face; scribed WPS14BT.

Metal location posters on BT's.

Dated March 16, 1987.

Restored by

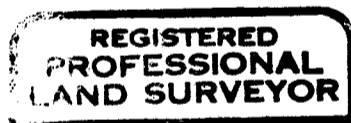

Anthony J. Klosterman

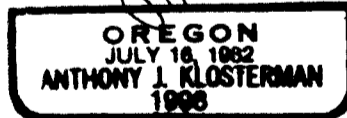

Present and witnessed by David B. Buchholz
Clifford R. Foster

