

RESTORED CORNER FOR STATE OF OREGON - DEPARTMENT OF FORESTRY

One quarter corner common to Sections 21 and 28, T2N, R8W, W.M., Tillamook County, Oregon.

ORIGINAL by Henry Meldrum, August 25, 1891.

42" Fir with scribes 1/4 S on North and South sides; now 38" x 7 ft. high rotten stump, in place, with portions of burnt scribes on N. side. Also cruiser marks on NW side and from which a:

- 20" Hemlock bears N05° E 11 lks.; missing.
- 10" Hemlock bears S32° W 47 lks.; missing.

REWITNESS by Louis W. Amort RE 2311, December 14, 1954 (Book 1, Page 163, Tillamook County Records).

From center of corner tree a:

- 36" Fir snag bears N83° W 21.9 ft.; now a 36" stump, in place, with scribes / S21BT 2311 visible.
- 48" Fir snag bears S36° W 55.0 ft.; now a 48" stump, in place, with scribes 1/4S28BT visible.
- 4"x4"x84" white painted cedar post south 3 ft.; now out of place.

RESTORED

Var. 21 1/2 E

Set 5/8"x36" steel re-bar with yellow plastic cap marked "LS 1998", 34 inches into center of stump, and from which a:

- 8" Fir bears N89° W 18.3 ft. to face; scribed 1/4S21BT.
- 8" Fir bears S37 1/2° E 26.4 ft. to face; scribed 1/4S28BT.

Set 4"x4"x60" white painted cedar post South 4.4 ft. from corner pipe. Oregon State Forestry Department metal location poster on NW BT. Also poster on South side of corner stump.

Dated December 30, 1986.

Restored by David B. Buchholz under my direction.  
David B. Buchholz, Survey Crew Chief

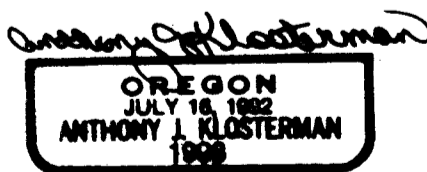
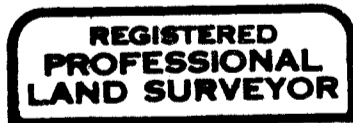

Present and witnessed by Clifford R. Foster

