

County Surveyor's Record, Tillamook County, Oregon

CHAINS

RESTORED CORNER FOR STATE OF OREGON - DEPARTMENT OF FORESTRY

Line tree common to Sections 31 and 36, T4N, R7 & 8W, W.M.,
Clatsop County, Oregon.

ORIGINAL by Henry Meldrum, October 6, 1891.

84" Fir bears South 15.12 chains from the section corner
common to 25, 30, 31 and 36; now a 78" stump, in place,
with two notches on north side.

Newer blazes found North and South.

RESTORED

Var $21\frac{1}{2}^{\circ}$ E

Set 5/8" x 34" steel re-bar with yellow plastic cap marked
"LS 1998" 32 inches into center of stump, and from which
a:

17" Spruce bears $S66\frac{1}{2}^{\circ}$ W 11.1 ft. to face; scribed
APS36BT.

15" Hemlock bears $S86\frac{1}{2}^{\circ}$ E 83.9 ft. to face; scribed
APS31BT.

Center line of Four Seven Ridge Road bears East 66.0
ft. course $S03^{\circ}$ E by $N03^{\circ}$ W.

Oregon State Forestry Department metal location poster
on BT's.

Dated September 17, 1986.

Restored by

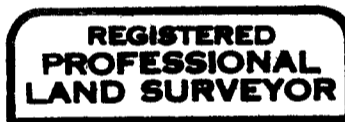

Anthony J. Klosterman

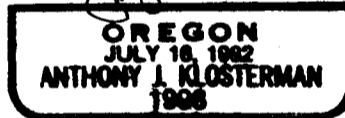

Present and witnessed by David B. Buchholz
Clifford R. Foster

