

County Surveyors' Record, Tillamook County, Oregon

CHAINS

RESTORED CORNER FOR STATE OF OREGON--DEPARTMENT OF FORESTRY

Section corner common to Sections 4, 5, 32, and 33, T3&4N, R7W, W.M., Tillamook and Clatsop Counties, Oregon.

ORIGINAL by Henry Meldrum, November 19, 1891:

Post; missing from which a:

- 48" Fir bears N82°E 19 lks.; now 40" snag, partial scribing visible on open face, cruiser marks and blazes above face.
- 18" Hemlock bears S3°E 29 lks.; missing.
- 20" Fir bears N73°W 24 lks.; remains of root crown in place.
- 48" Fir bears S42°W 27 lks.; now 36" stump, scribes BT visible on open face.

Line blazes East and West.

RESTORED

VAR. 21½°E

Set 1½ X 36" galvanized iron pipe with 3" bronze cap marked "OREGON BOARD OF FORESTRY T4N R7W S32 S33 S5 S4 T3N 1984 RS 1998", 34 inches in ground, and from which a:

- 6" Fir bears S59°W 21.5 ft. to face; scribed T3NR7WS5BT.
 - 13" Fir bears S80°E 43.8 ft. to face; scribed T3NR7WS4BT.
 - 9" Fir bears N50°E 69.0 ft. to face; scribed T4NR7WS33BT.
- No tree within limits in NW quadrant.

Set 4" X 4" X 60" white painted Cedar post S20°W 1.5 ft. from corner pipe.

Oregon State Forestry Department metal location posters on new BTS.

Also poster on original 48" Fir BT N82°E 19 lks.

Dated April 19, 1984

Restored by:

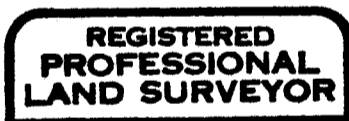

Anthony J. Klosterman

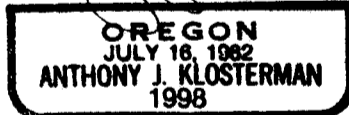

Present and witnessed by David B. Buchholz

