

CERTIFIED RECORD OF LAND CORNER MONUMENTATION

History of original corner establishment:

None

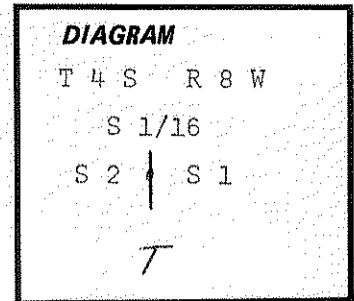

Description of corner evidence found:

None

SEE MAP B-970
FOR RESET OF THIS
CORNER
4/13/81
Allan Duncan C.S.

Description of monument and accessories established to perpetuate the original location of this corner:

At proportionate measurement I set a 2 1/2" X 30" galvanized iron pipe with a flared bottom and a brass cap riveted to the top marked.

T 4 S R 8 W
S 1/16
S 2 | S 1
1977
RLS 1073

From Which,

17" Douglas Fir 58.4 feet, N 13° W
mkd: "S 1/16 S 2" "B.T."

21" Alder 104.3 feet, N 86° W
mkd: "S 1/16 S 2" "B.T." Bark scribed

I set a 6' steel fence post with a Land Survey Monument sign and a Property Boundary sign. All bearing trees have brass washers. Attention signs, bearing tree tags and red painted bands.

Witness: Monte Cook

See map B-764

D. Mike Gaitson
Engineering Technician

Office of County Surveyor County of TILLAMOOK
State of OREGON, I hereby certify that the within instrument was filed in this office
for record on the 24 day of AUGUST, 1977
Edgar R. Cook by County Surveyor
(COUNTY OFFICIAL) (DEPUTY)

REGISTERED
PROFESSIONAL
LAND SURVEYOR

Kenneth M. Wightman

OREGON
JULY 17, 1970
KENNETH M. WIGHTMAN II
942

REGISTERED
PROFESSIONAL
LAND SURVEYOR

Edgar R. Cook

OREGON
JULY 30, 1975
EDGAR R. COOK
1073

Form R6-7100-57 (9/71)

Book 6

pg 37

TIMBERLAND SERVICES, INC.
1010 Airport Road - P O Box 668
Albany, Oregon 97321
Telephone (503) 926-9404
LAND SURVEYING - ENGINEERING
LAND USE PLANNING - ROADS
FORESTRY CONSULTING

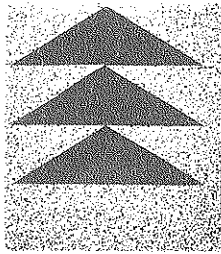

TIMBERLAND

Services, Inc.

(503) 926-9404

1010 AIRPORT ROAD — P. O. BOX 668 — ALBANY, OREGON 97321

August 16, 1977

Mr. John Carlich
Tillamook County Surveyor
Tillamook, Oregon 97141

Dear John:

Enclosed is a revision to one of the corner monumentation forms we submitted with our CS B-764. We found a discrepancy in the set for our corner "R". The corner has been correctly reset. The plat is correct, however, the bearing trees for this corner have been changed.

We would appreciate having two (2) copies of this new form showing its recordation.

Thank you.

Sincerely,

Ron Cook
Land Surveyor

ERC:pgk
enc.

FILE NO 458
2
TIMBERLAND

Services, Inc.

(503) 926-9404

1010 AIRPORT ROAD - P. O. BOX 668 - ALBANY, OREGON 97321

August 18, 1977

Mr. Cooper
Star Rt. Box 105
Beaver, Oregon 97108

Dear Mr. Cooper:

We have been advised that you are concerned about the position of the south 1/16 corner between Sections 1 and 2 which we set as a part of our subdivision of Section 2 for the U.S. Government.

The Tillamook County Surveyor has no record of this corner ever having been legally set. In 1973, when Mr. Carlich performed that work for you, he found a pipe of unknown validity and so stated on his County Survey No. A-2480. We found a bent 4' length of pipe in a stone mound about 64 feet south of the true corner point. We have rechecked our computations and our field work and, to the best of our knowledge, the brasscap we set is in the proper position.

This corner will control the subdivision of the southwest quarter of Section 1 when Section 1 is legally subdivided.

Enclosed is a copy of our record of survey for the work we did in Section 2. If you have any further questions, please contact us.

Sincerely,

Ron Cook

Ron Cook
Land Surveyor

See

B.764

ERC:pgk

enc.

cc: Mr. Frank Wranti, U.S. Forest Service
Siuslaw National Forest

Mr. John Carlich, Tillamook County Surveyor

COOPER & JONES TRACT

SECTIONS 1, 2, 4 S, 8 W U.M.

TILLAMOOK COUNTY, ORE.

SCALE: 1 INCH = 660 FEET

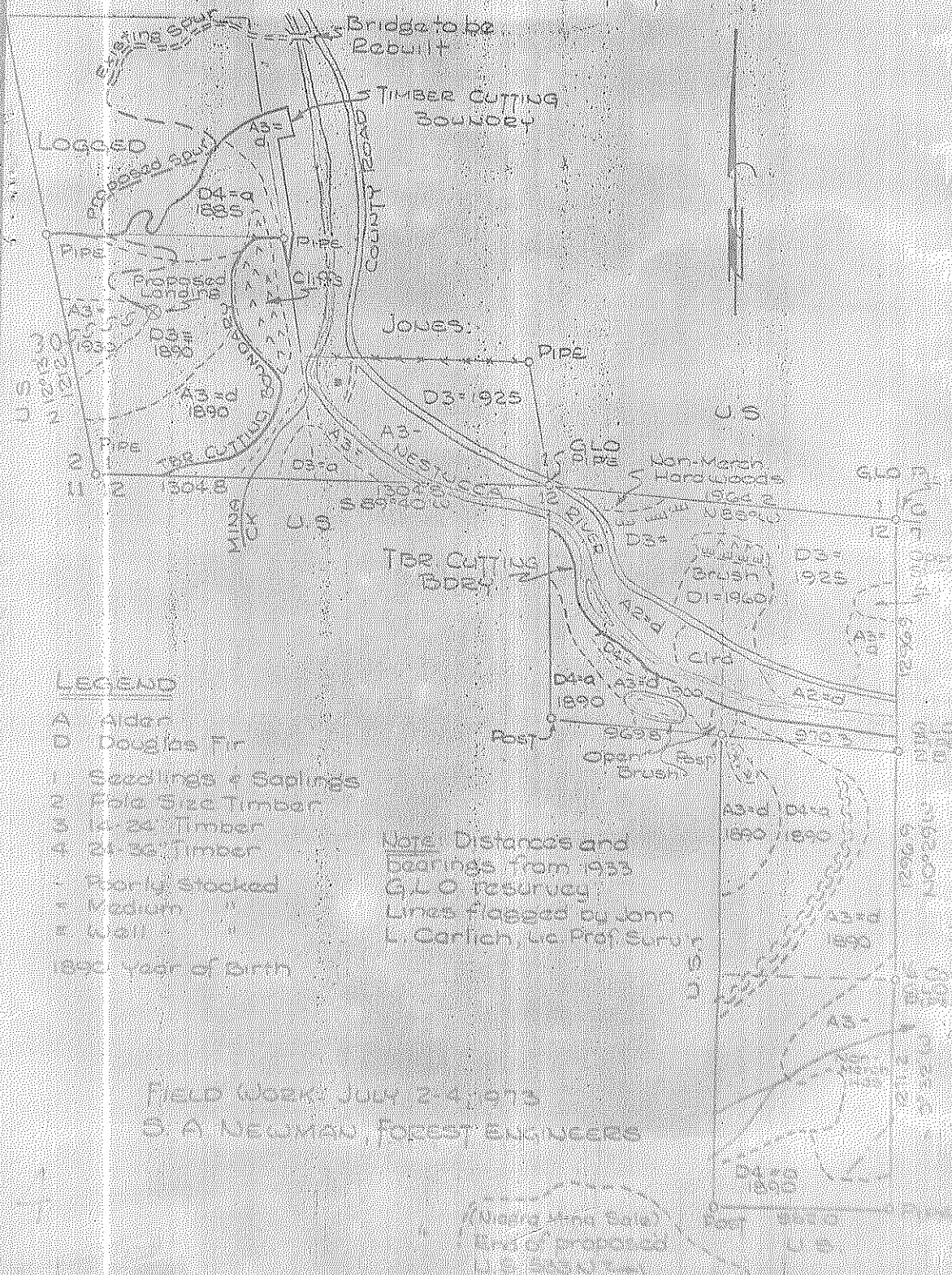

LEGEND

- A Alder
- D Douglas Fir
- 1 Seedlings & Saplings
- 2 Pole Size Timber
- 3 14-24 Timber
- 4 24-36 Timber
- Priority Stocked
- = Medium
- ≡ Well
- 1890 Year of Birth

NOTE: Distances and bearings from 1933 G.L.O. resurvey. Lines flagged by John L. Carlich, Lic. Prof. Surveyor

Field Work: July 2-4, 1973
S. A. NEWMAN, FOREST ENGINEERS

A-2480