

CERTIFIED RECORD OF LAND CORNER MONUMENTATION

History of original corner establishment:

Corner established by Charles E. Branson, Deputy Surveyor under contract No. 687, dated June 8, 1898. Record states:

Set cedar post, 5 ft. long, 4 ins. sq., 24 ins. in the ground, for corner of Secs. 16, 17, 20 and 21, Mkd: T4S S16 on NE, R9W S21 on SE, S20 on SW, S17 on NW faces, with 3 notches on the S. and 4 notches on E. edges; from which:

An alder, 8" diam., bears N35-1/2°E, 24 lks dist., mkd T4S R9W S16 BT.

An alder, 12" diam., bears S48°E, 17 lks dist., mkd T4S R9W S21 BT.

An alder, 14" diam., bears S57-1/2°W, 18-1/2 lks dist., mkd T4S R9W S20 BT.

An alder, 6" diam., bears N56°W, 44 lks dist, mkd T4S R9W S17 BT.

M. Whitmore found NE alder BT with scribing T4S R9W S16 March 4, 1961.

M. Whitmore, Deputy Surveyor, Tillamook Co., perpetuated and recorded this corner on March 4, 1961.

Description of corner evidence found:

1-1/2" diam. pipe 2 ft. above ground.  
Stone 20"x16"x6" on north side and against pipe.  
No markings on stone noted.

46" spruce, N6°W, 42.5 ft., healed scribe, set by M. Whitmore Mar. 4, 1961.  
34" spruce, N33°E, 73.0 ft., healed scribe, set by M. Whitmore Mar. 4, 1961.  
Alder stump, S57-1/2°W, 12.2 ft, fits position of original BT, badly decayed.  
Alder stump, S48°E, 11.2 ft., fits position of original BT, badly decayed.

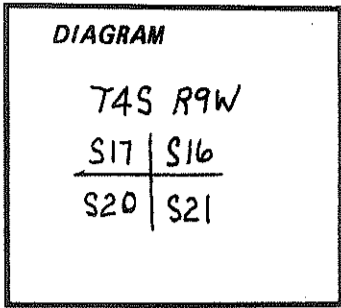

Description of monument and accessories established to perpetuate the original location of this corner:

Set a 30" X 3" diam. aluminum cap 6" above ground.  
Set 20"x16"x6" stone on south side against cap.  
Set 1-1/2" diam. pipe 3 ft. above ground next to cap.  
Cap mkd:

Cap information is also stamped at the base of the cap post.  
Cap has a magnet in the top and in the break away base.

New B.T.'s:

24" alder, S53°E, 58.7 ft., bark scribed: T4S, R9W, S21 BT, also placed brass washer at base of BT mkd: "LS 1050".

Set 1/2" diam. X 2-1/2 ft. long iron rod 1/2 ft above ground, S70°W, 12.7 feet from corner with rocks piled around it as a reference monument.

Painted 6" bands around B.T.'s with red paint.  
New B.T. tags.  
Attention signs on back side of B.T.'s.  
6 ft. metal fence post with attention sign 3 ft. west of corner.

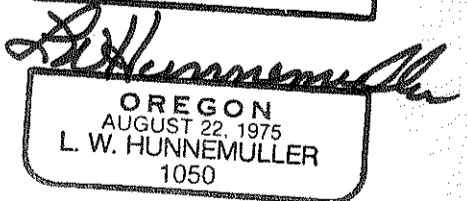
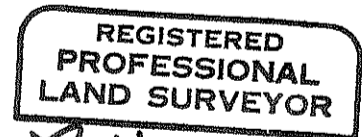
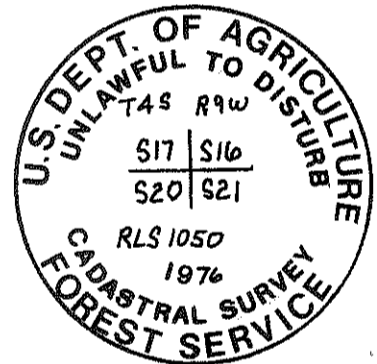

Witnessed by D. Schilder  
Office of County Surveyor County of Tillamook  
State of OREGON I hereby certify that the within instrument was filed in this office  
for record on the 20 day of AUGUST, 1976  
[Signature] by [Signature]  
(COUNTY OFFICIAL) (DEPUTY)