

CERTIFIED RECORD OF LAND CORNER MONUMENTATION

History of original corner establishment:

Corner established by Henry Meldrum, Deputy Surveyor, under contract No. 301, dated Sept. 13, 1878. Original survey states:

Set fir post 5 ft long, 4 ins. diam., for 1/4 section corner from which:

- A fir, 24" diam., bears N82°E, 67 lks. dist.
- A fir, 60" diam., bears S47°W, 20 lks. dist.

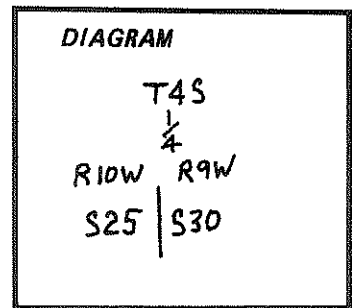

M. Whitmore, Deputy Surveyor, Tillamook Co., perpetuated and recorded this corner on May 18, 1952.

Description of corner evidence found:

3/4" diam. pipe 3 ft. above ground set by M. Whitmore, 18 May 1952.

- 24" fir snag, N82°E, 44.2 ft., scribing gone (original B.T.).
- 42" fir snag, S47°W, 15.0 ft., scribing gone (original B.T.).
- 18" alder, N57°W, 9.3 ft., bark scribed: 1/4 S25 BT. Done by M. Whitmore 18 May 1952.
- 36" alder, N44°E, 45.7 ft., bark scribed: 1/4 S30 BT. Done by M. Whitmore 18 May 1952.

M. Whitmore, U.S.F.S., 5/18/52, found 24" snag, N82°E, 67 lks., marked "1/4 SBT".

Description of monument and accessories established to perpetuate the original location of this corner:

Set 30" by 3" diam. aluminum cap 0.6 ft. above ground. Also set 3/4" diam. pipe 3 ft. above ground next to cap.

Cap is marked:

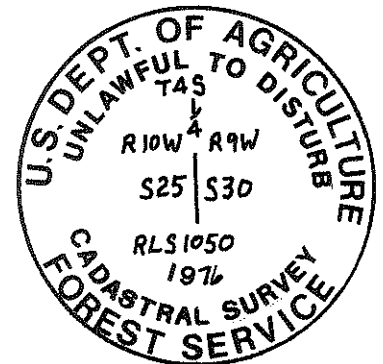

Cap information is also stamped at the base of the cap post. Cap has a magnet in the top and in the break away base.

- Painted 6" bands around B.T.'s with red paint.
- Attached new B.T. tags.
- Attention signs on back side of B.T.'s.
- 6 ft. metal fence post with attention sign 3 ft. south of corner.

Witnessed by D. Schildan.

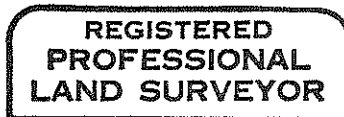

*L. W. Hunnemuller*

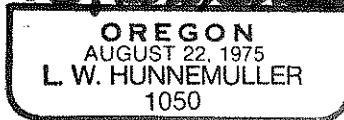

Office of County Surveyor County of Tillamook

State of OREGON, I hereby certify that the within instrument was filed in this office

for record on the 20<sup>th</sup> day of August, 1976

*J. L. Conlin*  
 (COUNTY OFFICIAL)

(DEPUTY)