

County Surveyor's Record, Tillamook County, Oregon

CHAINS

RESTORED CORNER FOR STATE OF OREGON--DEPARTMENT OF FORESTRY

Section corner common to Sections 10, 11, 14 and 15, T3S, R7W, W.M., Tillamook County, Oregon.

ORIGINAL

Stone 12x10x9 (Found in place, notches weathered away) from which a:

Ascend hill, crs. NW by SE, bears North 3 chains; found in place.
Brook 6 lks, crs. NW, bears West 3 chains; found 4 ft. creek,
crs. N50°W from S50°W, 236 ft.

Found line blazes to the North:

196 ft. - blaze on West edge 24" x 20 ft. high Fir stub.
293 ft. - blaze on East edge 36" x 15 ft. high Fir stub.

RESTORED

Var. 21½°E

Set 1½" x 36" galvanized iron pipe with 3" bronze cap marked "OREGON STATE BOARD OF FORESTRY T3S R7W S10 S11 S14 S15 1974 RS 707", 34 inches in ground, in place of stone, with corner stone 6 ft. North of pipe, in mound of rock, and from which a:

23" Fir bears N14°E 5.9 ft. to face; scribed T3S R7W S11 BT.
28" Fir bears S15°W 22.6 ft. to face; scribed T3S R7W S15 BT.
20" Fir bears S35°E 13.9 ft. to face; scribed T3S R7W S14 BT.
28" Fir bears N65°W 35.3 ft. to face; scribed T3S R7W S10 BTRS 707.
6" wide crk bears North 35 ft., crs N50°W from S50°E.

Set 4"x4"x60" white painted Cedar post 0.5 ft. SW of corner pipe. Oregon State Forestry Department metal location poster on 20" Fir BT.

Dated December 30, 1974.

Restored by

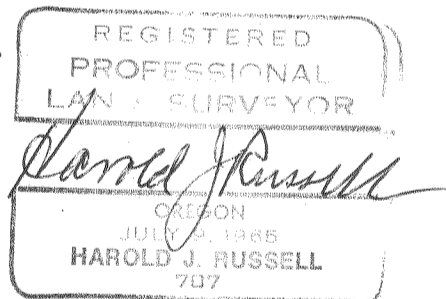

Present and witnessed by C. W. Cook
K. D. Whitehead
M. E. Nordin