

CERTIFIED RECORD OF LAND CORNER MONUMENTATION

History of original corner establishment:

This corner was originally set by the G.L.O. in 1879 under contract No. 301. They set a fir post 5'x4"x4" for the corner, from which:

- 48" Fir N 24° E 62 lks.
- 24" Fir S 16° W 29 lks.

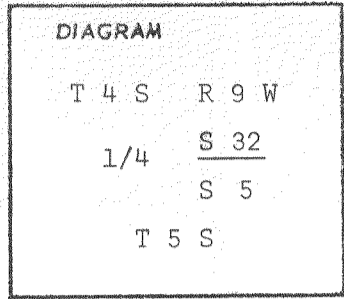

Description of corner evidence found:

In 1961 Leonard Whitmore, Deputy County Surveyor, found both bearing trees, but no evidence of the original post or any scribing. He found an old line blaze about 200 feet to the east. He set a 4"x4"x30" limb and marked two new BT's.

- 12" Fir S 57° W 5.5 feet
mkd. "1/4 S 5 BT"
- 9" Fir N 45° E 27 feet
mkd. "1/4 S 32 BT"

Description of monument and accessories established to perpetuate the original location of this corner

Since 1961 one of the original bearing trees, which are now snags, has slid down the hill. I found one original bearing tree and Whitmore's post and two bearing trees. I set a 2 1/2" x 30" galvanized iron pipe with a brasscap riveted to the top marked:

T 4 S R 9 W
1/4 S 32
 S 5
T 5 S
1975
RPLS 942

from which:

- 16" Fir S 62° W 5.5 feet
visible scribe scar
- 13" Fir N 45° E 27.6 feet
visible scribe scar

All bearing trees have been banded with red paint and attention signs and BT tags have been attached. All scribes have a 3/4" brass washer, with "LS 942" engraved on it, nailed in the face.

Witnessed: D. M. Jackson

Office of County of
State of, I hereby certify that the within instrument was filed in this office
for record on the day of

..... by
(COUNTY OFFICIAL) (DEPUTY)
Set this 6th day of February 1975

Edgar W. Lamb

Edgar W. Lamb
Engineers Aide

323

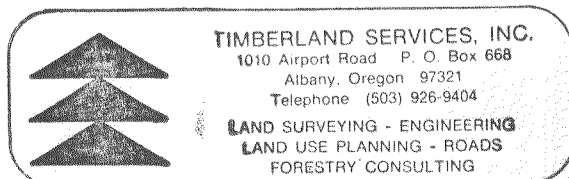
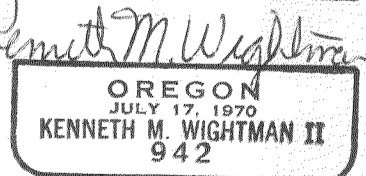
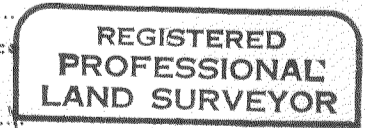

TIMBERLAND SERVICES, INC.
1010 Airport Road P. O. Box 668
Albany, Oregon 97321
Telephone (503) 926-9404
LAND SURVEYING - ENGINEERING
LAND USE PLANNING - ROADS
FORESTRY CONSULTING