

19

FIELD NOTES FOR SETTING THE  
E 1/6 COR. SEC. 7 & 18, T3N, R9W, W.M.  
(SEE MY SURVEY OF SEC. 18 & 19  
FOR POSITION OF THIS CORNER)

I SET FLUSH A 1 1/2" X 4 1/2"  
CONCRETE FILLED, GALV. IRON  
PIPE WITH 2" BRASS CAP  
STAMPED AS SHOWN:

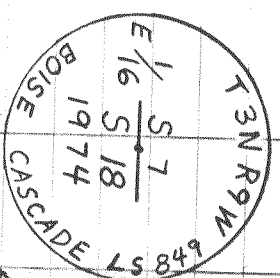

FROM WHICH BEAR  
THE FOLLOWING BEARING  
TREES SCRIBED BY  
BOISE CASCADE CORP.

IN 1970:  
A 24" HEMLOCK BEARS N81°W 38.75'  
TO BOTTOM OF FACE SCRIBED  
"E 1/6 S 7 BT"

A 18" HEMLOCK BEARS N75°E 50.95'  
TO FACE SCRIBED "E 1/6 S 7 BT"

WITNESSES: H FOEESTE, L.S. 849  
DATE: 12/74

*H. Foerste*  
*A. Hopmann*

20

FIELD NOTES FOR SETTING THE  
N 1/6 COR. SEC. 17 & 18, T3N, R9W, W.M.  
(SEE MY SURVEY OF SEC. 18 & 19.  
FOR POSITION OF THIS COR.)

I SET FLUSH A 1 1/2" X 3 6"  
CONCRETE FILLED, GALV. I. P.  
WITH 2" BRASS CAP STAMPED  
AS SHOWN:

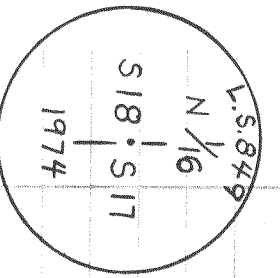

FROM WHICH I SCRIBED  
TWO BEARING TREES:

A 14" FIR BEARS S75°W  
21.33' TO FACE SCRIBED  
"N 1/6 S 18 BT"

A ALDER BEARS S 41°E 11.35'  
TO FACE SCRIBED "N 1/6 S 7 BT"

WITNESSES: H FOEESTE, L.S. 849  
DATE: 12/74

*H. Foerste*  
*A. Hopmann*

REGISTERED  
PROFESSIONAL  
LAND SURVEYOR

*Karl F. Foeste*

OREGON  
JULY 12, 1968  
KARL F. FOESTE  
0849