

CERTIFIED RECORD OF LAND CORNER MONUMENTATION

History of original corner establishment:

This corner was set by Albert P. Wilson under Contract No. 555 dated June 25, 1890. He located this corner 80.00 chs. North of corner to Section 12|13. At that time he set a post:

"80.00 chs. Set post 4 in. sq., 4 ft. long, 24 in. in ground for corner to Sec. 1, 12, 6, 7, mkd. T.6 S., R.11 W. S 1 on NW., T.6 S., R.10 W. S 6 on NE, T.6 S., R.10 W. S 7 on SE, T.6 S., R.11 W. S 12 on SW face; 5 notches on S & on N face from which:

- |   |  |
|---|--|
| 30" Cedar N. 64° E. 44 lks.<br>mkd "T.6 S., R.10 W. S 6 BT" | 7" Hemlock N. 13° W. 11 lks.<br>mkd "T.6 S., R.11 W. S 1 BT" |
| 40" Cedar S. 7° E. 43 lks.<br>mkd "T.6 S., R.10 W. S 7 BT"  | 10" Alder S. 30° W. 28 lks.<br>mkd "T.6 S., R.11 W. S 12 BT" |

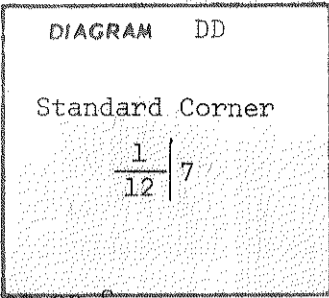

Description of corner evidence found:

November 9, 1890"

I found a 3/4" iron pipe 12" above ground in a stone mound. The NE & SE BT's are standing. I found no evidence of the NW or SW BT's.

Reference:

Plat dated July, 1973  
by Timberland Services,  
Inc. under my stamp.

Description of monument and accessories I established to perpetuate the original location of this corner

On 11 November 1890 Wilson set a closing corner for S 6 & S 7 4.07 chs. North. That would make this corner common to S 1 & S 12 only.

I set a 2 1/2' X 30" galvanized iron pipe with a flared bottom and a brasscap riveted to the top marked:

T 6 S  

$$\frac{S 1}{S 12} \Big| R 10 W$$
 R 11 W  $\Big|$  S 7  
 1973  
 RLS 942

From which:

- 46" Cedar N 64° E 44 lks (to face)  
mkd "S" visible (original BT)
- 63" Cedar S 7° E 43 lks (to face)  
mkd "S" visible (original BT)
- 32" Hemlock S 2° W 32.1 ft. (to centerline)  
mkd "T 6 S R 11 W S 12 BT"

No tree available in NW quadrant. Reset pipe 0.5' E.

I placed a small stone mound around the brasscap. The corner lies on top of a small spur ridge approximately 300 ft. S 20° W from road.

Aspect: N. 20° E.

Slope: 18%

Witnessed: E. W. Tatro

Office of TILLAMOOK Co Surveyor County of TILLAMOOK  
 State of OREGON I hereby certify that the within instrument was filed in this office  
 for record on the 22 day of AUGUST, 1973, at 9 o'clock A. m., (signed)  
E. W. Tatro by \_\_\_\_\_ (DEPUTY)  
 (COUNTY OFFICIAL)

Set this 22nd day of May 1973.

BOOK 5

258

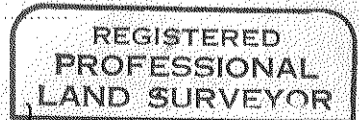

*Kenneth M. Wightman*

