

CERTIFIED RECORD OF LAND CORNER MONUMENTATION

History of original corner establishment: *None*

IN T55 R10W W.M.

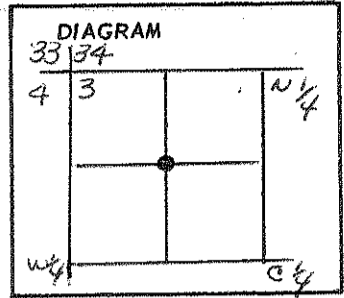

Description of corner evidence found: *NONE*

Description of monument and accessories I established to perpetuate the original location of this corner

Set 2" x 30" galvanized iron pipe, flared at the bottom and a brass cap riveted on top and extending 2" above the ground.

Stamped disk →

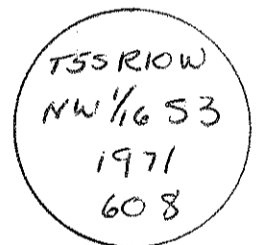

Set steel posts with Forest Service signs 4.0 ft west and 5.0 ft north of monument.

New bearing trees as follows:

18" spruce scribed "NW 1/6 S3 BT" S 81° 50' W 37.33 ft.

11" spruce scribed "NW 1/6 S3 BT" S 27° 20' E 55.79 ft.

Placed U.S.F.S. Bearing tree signs on each tree breast high facing monument.

Office of County Surveyor County of Tillamook

State of OREGON, I hereby certify that the within instrument was filed in this office

for record on the 16 day of June, 1971, at 9 o'clock A.m., (signed)

[Signature]
(COUNTY OFFICIAL)

by _____ (DEPUTY)

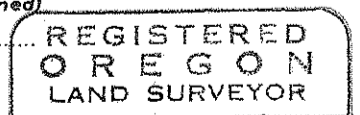

[Signature]
JULY 12, 1963
AUGUST C. GIERING
608

CLARK & GROFF ENGINEERS, INC.
3278 COMMERCIAL STREET S. E.
SALEM, OREGON

BOOK 5

Form R6-7100-57 (9/66)

BOOK 5