

CERTIFIED RECORD OF LAND CORNER MONUMENTATION

History of original corner establishment:

Corner established General Land office  
Contract Survey (Page 53 Co Surveyor's Records Tillamook Co)

Records state Set post for 1/4 sec. cor. from  
which an alder 12" in diameter bears N72°W  
2881Ks distant.  
an alder 9" in diameter bears N20°E  
4961Ks distant.

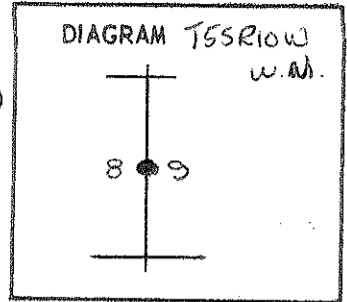

Description of corner evidence found:

Found 6" x 8" x 15" stone with 1/4 marked on west side.  
stone accepted by U.S. Forest Service.

Description of monument and accessories I established to perpetuate the original location of this corner

Set 2" x 30" galvanized iron pipe flared at the bottom with a brass cap riveted on top 12" below the surface of the ground in the position of the stone. Set stone along side.

Set steel post with Forest Service sign  
2.5 ft. West of Corner

stamped disk



Set Reference monument S 15° 30' W 10.42 ft.

2" x 30" galvanized iron pipe with brass disk marked  
"1/4 58 RM 1971 608". Set steel post with Forest Service  
signs 1.0 ft south of monument. Monument flush with ground.

Set reference monument S 79° 30' E 27.85 ft 2" x 30" galvanized  
iron pipe flush with the ground with Brass cap marked  
1/4 59 RM 1971 608. Set steel post with Forest Service signs  
1.0 ft East of monument.

COUNTY SURVEYOR

Office of TIEGA County of TILLAMOOK  
State of OREGON, I hereby certify that the within instrument was filed in this office  
for record on the 16 day of JUNE, 1971, at 9 o'clock A.m., (signed)  
[Signature] by \_\_\_\_\_  
(COUNTY OFFICIAL) (DEPUTY)

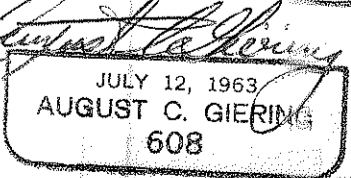
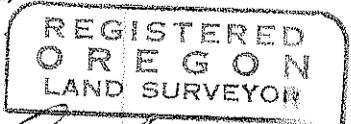

BOOK 5

CLARK & GROFF ENGINEERS, INC.  
3276 COMMERCIAL STREET S. E.  
SALEM, OREGON