

County Surveyor's Record, Tillamook County, Oregon

CHAINS

(164)

NE 1/4 Sec 21 259

Found 2 1/2" Iron Pipe - leaning Southly
 Set By W E Anderson ^{GIS} For NE 1/4
 Cor. in E-W & S Fence Cor.
 I set Pipe straight & put it
 Down within 1" of Ground
 Also set a 4x4x48 White Cedar Post
 0' East of Cor.

New Bearing Tree
 18" Double Hem. ^{True Bearing} N 75° 00' W 256.85
 Scribed NE 1/4 S 21 BT CS
 (Found)
 1" Iron Pipe Westly 43.58

BOOK 5

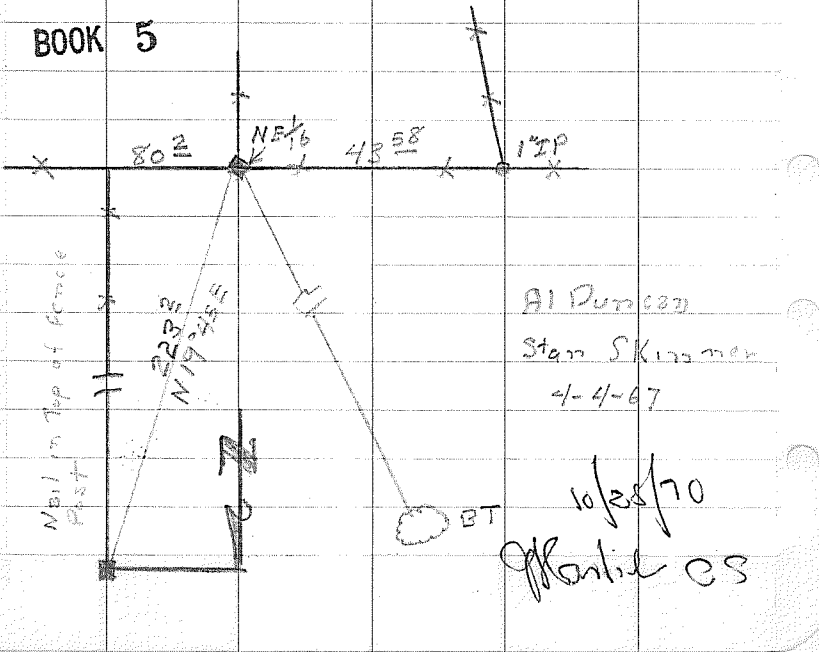

Al Duncan
 Star Skinner
 4-4-67

10/28/70
 Marked CS

BOOK 5